

Lean conveyor tracks with rail holder



- ▶ Aluminum U-profile conveyor track
- ▶ Conveyor media to meet all requirements:
 - Rollers with or without roller flange. Four colors to visually identify inventories (Kanban) or to differentiate between good and reject parts.
 - Roller elements with and without roller flange (RE45, RE45SK)
 - Slide rails with or without integrated lateral guide (GS, GSSK)
- ▶ Rail holders for suspending to tubular cross tie
- ▶ Available as ESD-conductive version (U-profile: aluminum plain)

Scope of delivery: conveyor track consisting of two conveyor sections (right/left) with rail holders

MTpro For workstation design and planning, we recommend **MTpro!** See pages 12 and 13 for more information.

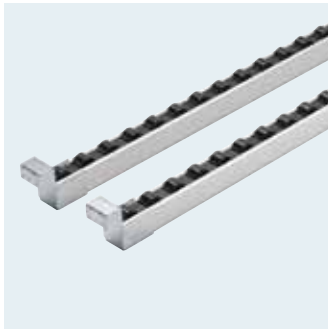

00121021

Conveyor track with rail holder, single-color rollers		3 842 998 381
ESD	Conductivity	Yes, no
TM	Horizontal distance between tubular cross ties	355 ... 6000 mm
G	Gradient	0 ... 10% (recommended: 6%)
FM	Conveyor medium	Rollers with d = 32 mm with/without roller flange, various spacings
F	Roller color	Black, red, yellow, green
S	Rail holder design	With/without stop
SF	Lateral guide	With, without

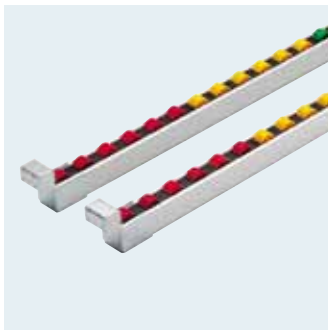

00121018

Conveyor track with rail holder, multi-color rollers		3 842 998 382
ESD	Conductivity	Yes, no
TM	Horizontal distance between tubular cross ties	355 ... 6000 mm
G	Gradient	0 ... 10% (recommended: 6%)
FM	Conveyor medium	Rollers with d = 32 mm with/without roller flange, various spacings
F1	Roller color	Black, red, yellow, green
NF1	Number of rollers in color 1	Max. 160
F2	Roller color	Black, red, yellow, green
NF2	Number of rollers in color 2	Max. 160
F3	Roller color	Black, red, yellow, green
NF3	Number of rollers in color 3	Max. 160
S	Rail holder design	With/without stop
SF	Lateral guide	With, without



00121032

Conveyor track with rail holder, slide rails		3 842 998 387
ESD	Conductivity	Yes, no
TM	Horizontal distance between tubular cross ties	355 ... 6000 mm
G	Gradient	0 ... 10% (recommended: 6%)
FM	Conveyor medium	Slide rails with/without border
S	Rail holder design	With/without stop
SF	Lateral guide	With, without



00121049

Conveyor track with rail holder, roller elements		3 842 998 385
ESD	Conductivity	Yes, no
TM	Horizontal distance between tubular cross ties	355 ... 6000 mm
G	Gradient	0 ... 10% (recommended: 6%)
FM	Conveyor medium	Roller element with/without border
S	Rail holder design	With/without stop
SF	Lateral guide	With, without

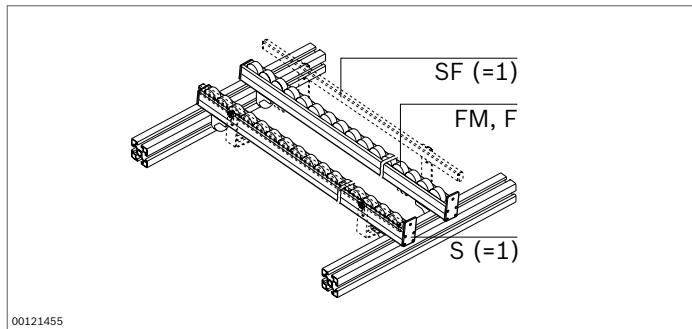

Lean conveyor track with stop plates



- ▶ Aluminum U-profile conveyor track
- ▶ Conveyor media to meet all requirements:
 - Rollers with or without roller flange. Four colors to visually identify inventories (Kanban) or to differentiate between good and reject parts.
 - Roller elements with and without roller flange (RE45, RE45SK)
 - Slide rails with or without integrated lateral guide (GS, GSSK)
- ▶ Applications include the manual linking of workstations
- ▶ Available as ESD-conductive version (U-profile: aluminum plain)

Scope of delivery: conveyor track consisting of two conveyor sections (right/left) with stop plates

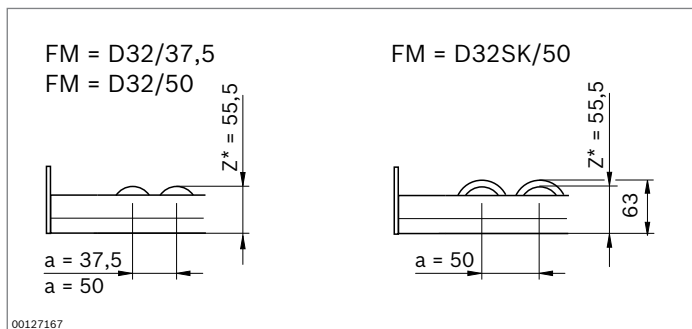
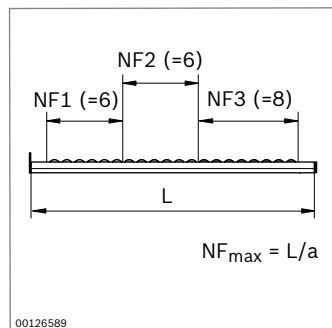
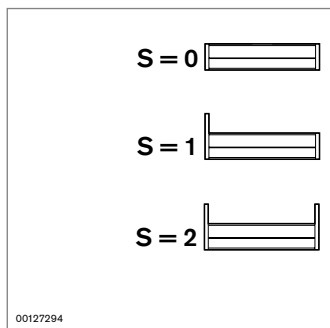
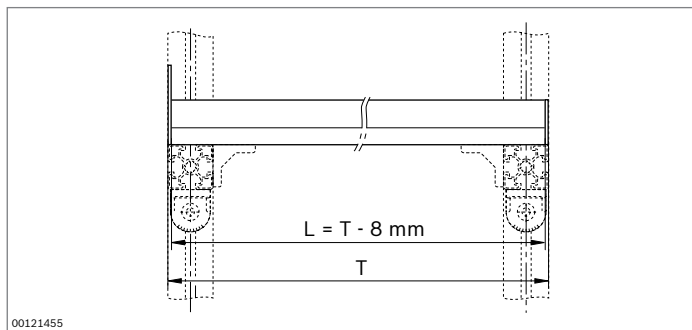

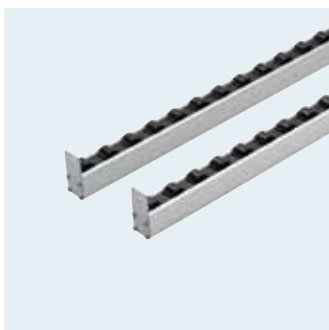

00127297

Conveyor track with stop plate, single-color rollers		3 842 998 383
ESD	Conductivity	Yes, no
L	Conveyor track length	355 ... 6000 mm
FM	Conveyor medium	Rollers with d = 32 mm with/without roller flange, various spacings
F	Roller color	Black, red, yellow, green
S	Stop plate version	With/without stop
SF	Lateral guide	With, without

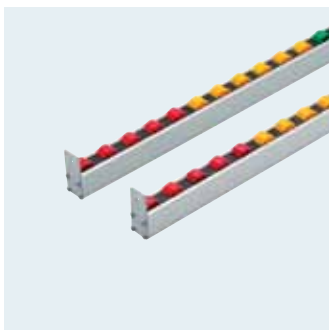

00127298

Conveyor track with stop plate, multi-color rollers		3 842 998 384
ESD	Conductivity	Yes, no
L	Conveyor track length	355 ... 6000 mm
FM	Conveyor medium	Rollers with d = 32 mm with/without roller flange, various spacings
F1	Roller color	Black, red, yellow, green
NF1	Number of rollers in color 1	Max. 160
F1	Roller color	Black, red, yellow, green
NF2	Number of rollers in color 2	Max. 160
F1	Roller color	Black, red, yellow, green
NF3	Number of rollers in color 3	Max. 160
S	Stop plate version	With/without stop
SF	Lateral guide	With, without



00127299

Conveyor track with stop plate, slide rails		3 842 998 388
ESD	Conductivity	Yes, no
L	Conveyor track length	355 ... 6000 mm
FM	Conveyor medium	Slide rails with/without border
S	Stop plate version	With/without stop
SF	Lateral guide	With, without

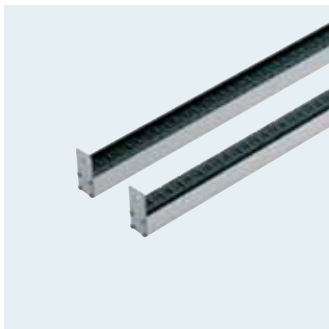

00127278

Conveyor track with stop plate, roller elements		3 842 998 386
ESD	Conductivity	Yes, no
L	Conveyor track length	355 ... 6000 mm
FM	Conveyor medium	Roller element with/without border
S	Stop plate version	With/without stop
SF	Lateral guide	With, without

Lean conveyor tracks – components

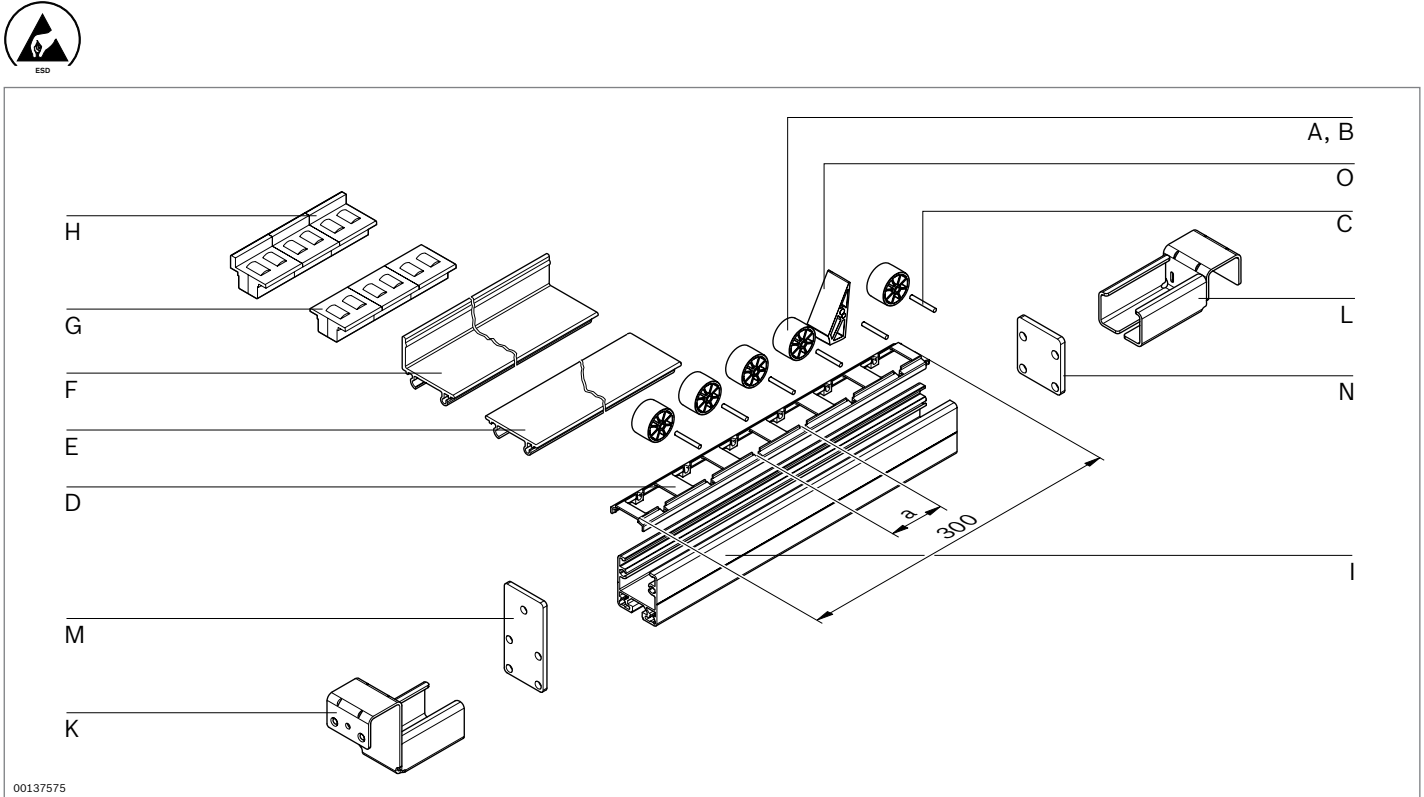

	a (mm)	ESD No.
A D32 roller, black		100 3 842 532 865
		100 3 842 537 961
	D32 roller, red	100 3 842 532 866
	D32 roller, yellow	100 3 842 537 960
	D32 roller, green	100 3 842 532 870
		100 3 842 537 959
B D32SK roller, black		100 3 842 532 867
		100 3 842 537 965
	D32SK roller, red	100 3 842 532 883
	D32SK roller, yellow	100 3 842 537 964
	D32SK roller, green	100 3 842 532 884
		100 3 842 537 963
C Steel axis		100 3 842 532 862
D D32/37.5 roller carrier		20 3 842 537 944
		20 3 842 537 945
D32/50 roller carrier	37.5	20 3 842 532 887
		20 3 842 538 094
D32SK/50 roller carrier	50	20 3 842 532 886
		20 3 842 537 947

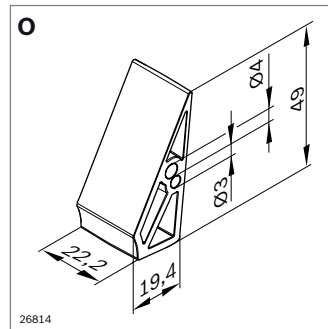
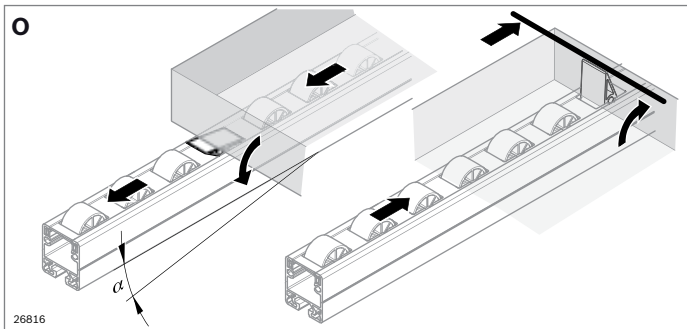
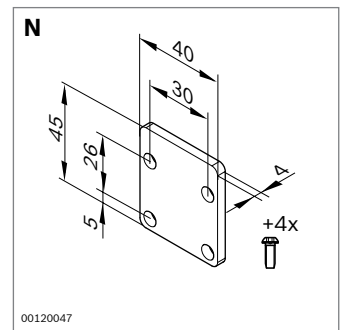
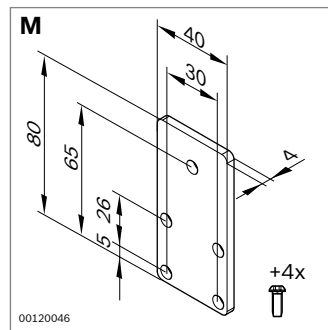
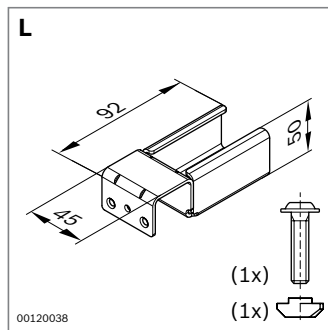
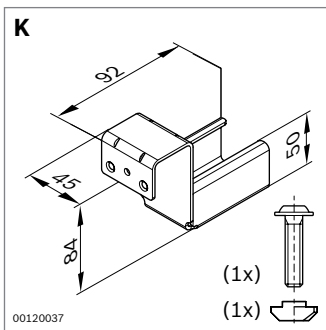
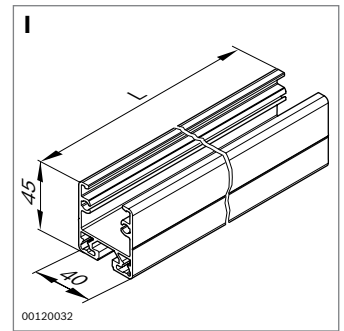
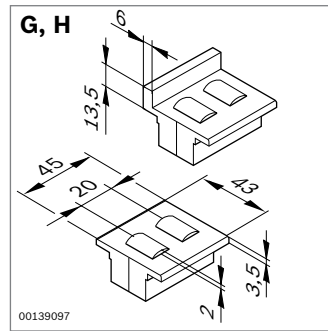
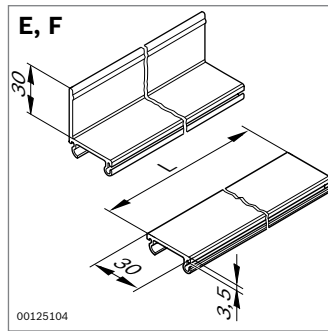
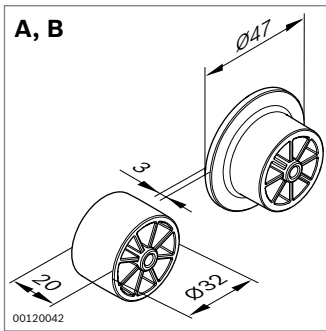

	L (mm)			ESD	No.
E Glider rail	3000		20		3 842 535 124
	3000		20		3 842 537 803
F Slide rail, lateral guide	3000		20		3 842 537 806
	3000		20		3 842 537 807
G RE45 roller elements	45		100		3 842 319 501
	45		100		3 842 538 064
H RE45SK roller elements	45		100		3 842 319 500
	45		100		3 842 538 065
I U-profile	30 ... 6000				3 842 993 316/L
	30 ... 6000				3 842 995 027/L
	6070	20			3 842 535 115
	6070	20			3 842 541 814
K Rail holder with stop			20		3 842 537 660
L Rail holder without stop			20		3 842 537 661
M 40x80 stop plate with stop			20		3 842 535 121
N 40x45 stop plate without stop			20		3 842 535 122
O XLean/Lean stopper			10		3 842 552 151



00129984

Lean – accessories



- ▶ **Flexible bridge (A)** for the ergonomic supply of containers in the flow rack system or at the workstation. The container is stopped at the flexible bridge and then manually moved to the ergonomic removal position. Maximum inclination (a_{\max}) compared to horizontal:
 - With tubular cross tie: $a_{\max} = 40^\circ$
 - With double tubular cross tie: $a_{\max} = 30^\circ$
- ▶ **Brake (B)** for bringing containers to a gentle stop
- ▶ **Tube clip (C)** for fastening conveyor tracks onto the tubular cross tie. Increased stability
- ▶ **Holder for double tubular cross tie (D)** for connecting conveyor track and double tubular cross tie. Increased stability

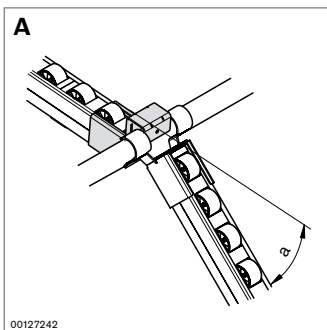

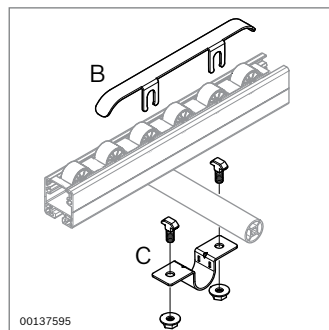

00127242

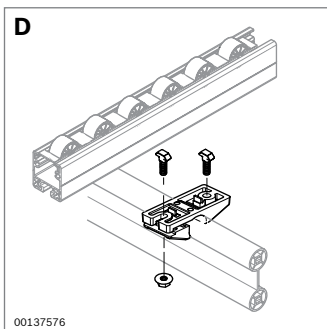

00137595



00137576

	ESD	ESD No.
A Flexible bridge	20	3 842 537 951
B D32/37.5 brake	20	 3 842 537 948
D32/50, D32SK/50 brake	20	 3 842 532 881
C D28 tube clip	20	3 842 535 364
D Holder for double tubular cross tie	20	3 842 537 720

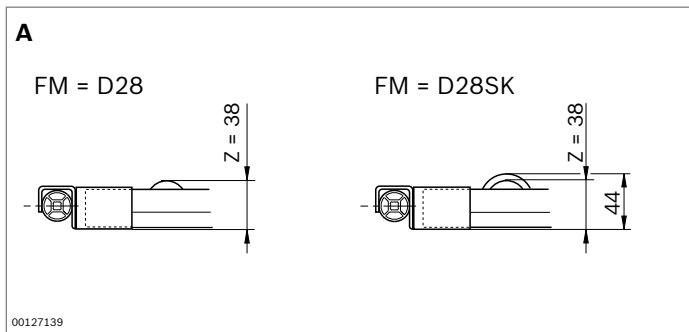

Conveyor tracks

XLean conveyor track with rail holder (A)

- Rollers with $\varnothing = 28$ mm with and without roller flange.

3 842 998 196 (see page 96)

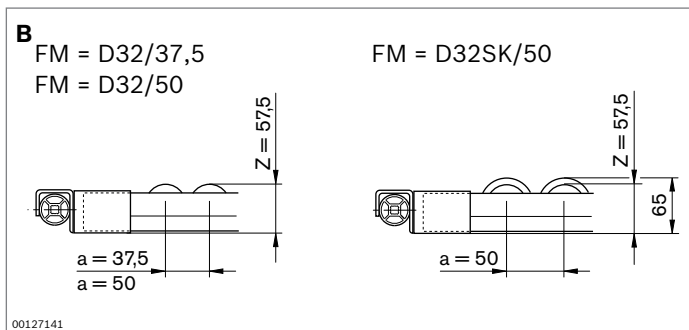

Lean conveyor track with rail holder (B)

- Rollers with $\varnothing = 32$ mm with and without roller flange.

3 842 998 381 (see page 101)

3 842 998 382 (see page 101)

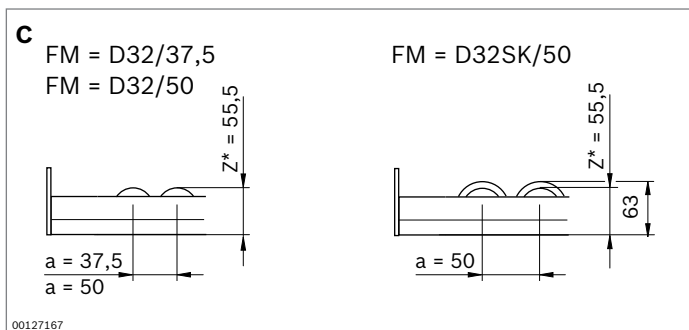

Lean conveyor track with stop plate (C)

- Rollers with $\varnothing = 32$ mm with and without roller flange.

3 842 998 383 (see page 103)

3 842 998 384 (see page 103)

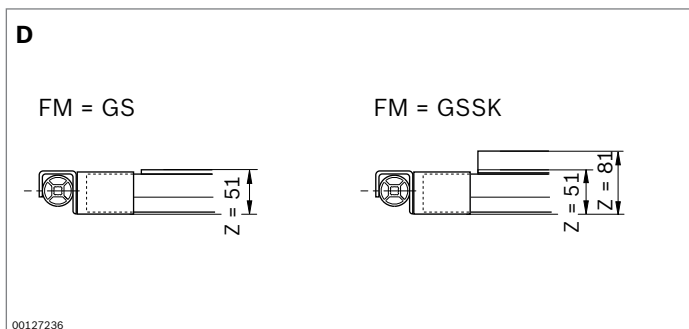

Lean conveyor track with rail holder (D)

- Slide rail with and without roller flange.

3 842 998 387 (see page 101)

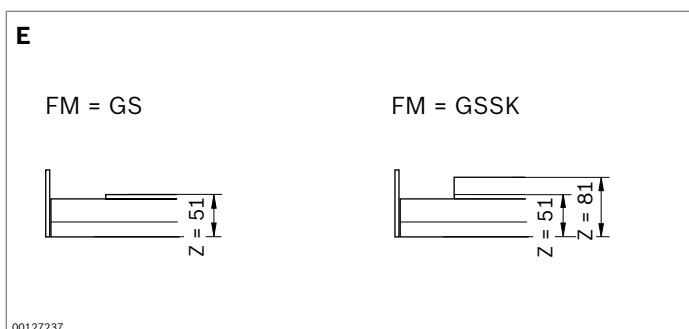

Lean conveyor track with stop plate (E)

- Slide rail with and without roller flange.

3 842 998 388 (see page 103)

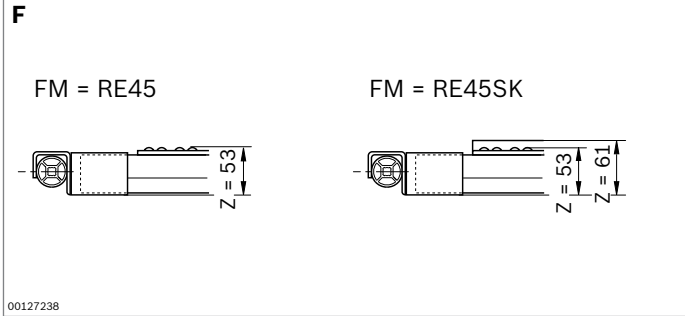

Lean conveyor track with rail holder (F)

► Roller elements with and without roller flange.

3 842 998 385 (see page 101)

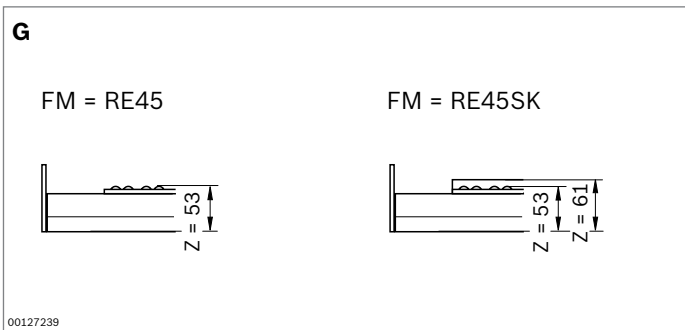

Lean conveyor track with stop plate (G)

► Roller elements with and without roller flange.

3 842 998 386 (see page 103)

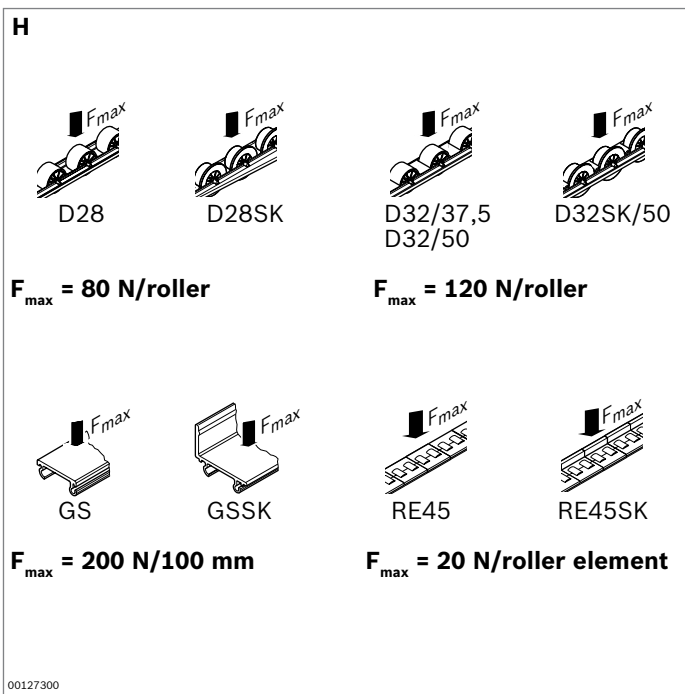

Conveyor media (H)

D28, D28SK (see page 97)

D32/37,5, D32/50, D32SK/50, GS, GSSK
(see page 100, 102, 104, 105)

RE45, RE45SK (see page 100, 102, 105)

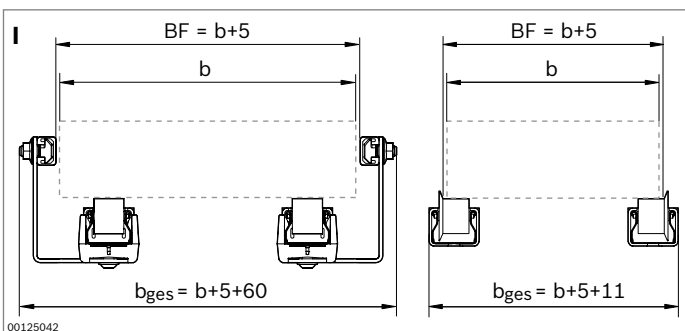

Conveyor tracks with and without lateral guide (I)

XLean conveyor track

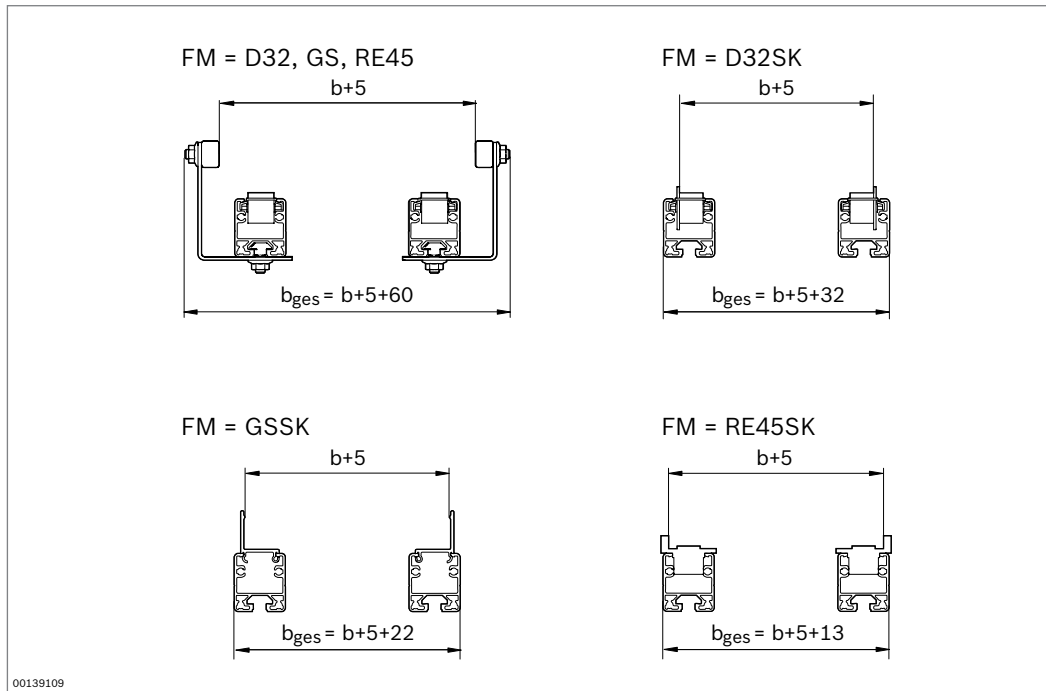

Lean conveyor track

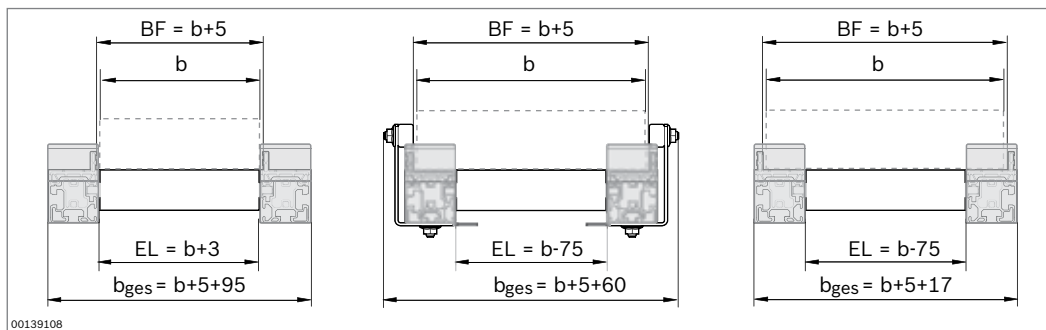

EcoFlow conveyor track with rail holder

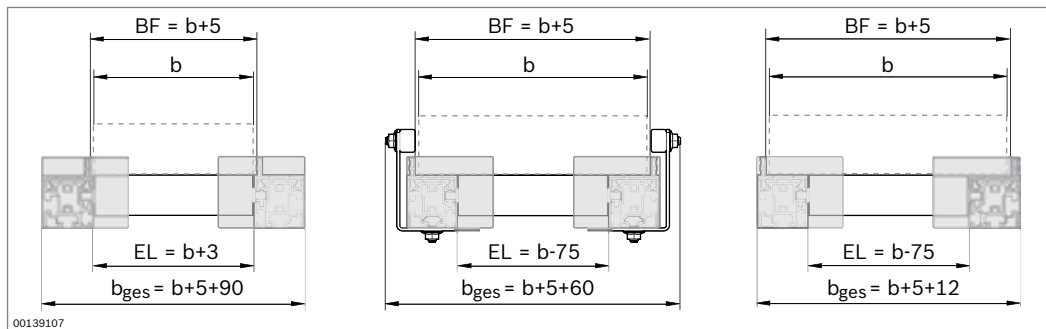

EcoFlow conveyor track with stop plate

EL = Roller length