

KU 2/90 curve

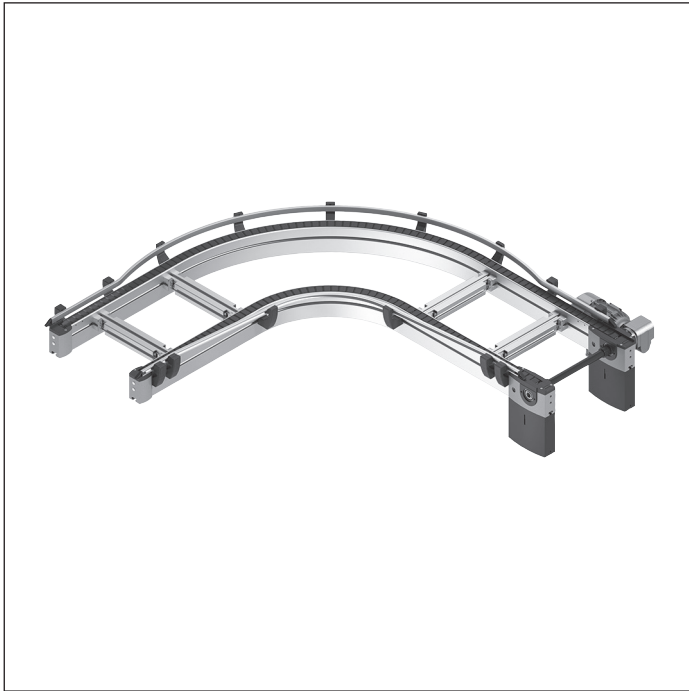

- ▶ 90° curve conveying of the workpiece pallet
- ▶ Curve with built-in drive
- ▶ Section loads up to 90 kg in accumulation operation
- ▶ Conveyor medium: Flat top chain
- ▶ Accumulation operation possible
- ▶ Plastic chain guides
- ▶ Automatic chain tensioning system
- ▶ Can be combined with WT 2, WT 2/F, WT 2/H and WT 2/F-H

Note:

- ▶ Flat top chain in ESD version is not permitted
- ▶ The LU 2 automatic lubrication unit is highly recommended for flat top chains:

The KU 2 curves with flat top chain conveyor medium have a built-in drive. They are suitable for use with high section loads in accumulation operation.

Accessories

Recommended accessories

- ▶ SZ 2 leg sets/..., see p. 6-2
- ▶ Accumulation pressure control, e.g., with WI/M rocker, see p. 8-133
- ▶ Connection kits, see p. 4-40
- ▶ LU 2 automatic lubrication unit, see p. 3-152

Delivery notes

Scope of delivery

- ▶ Curve, complete

Condition on delivery

- ▶ Fully assembled

Ordering information

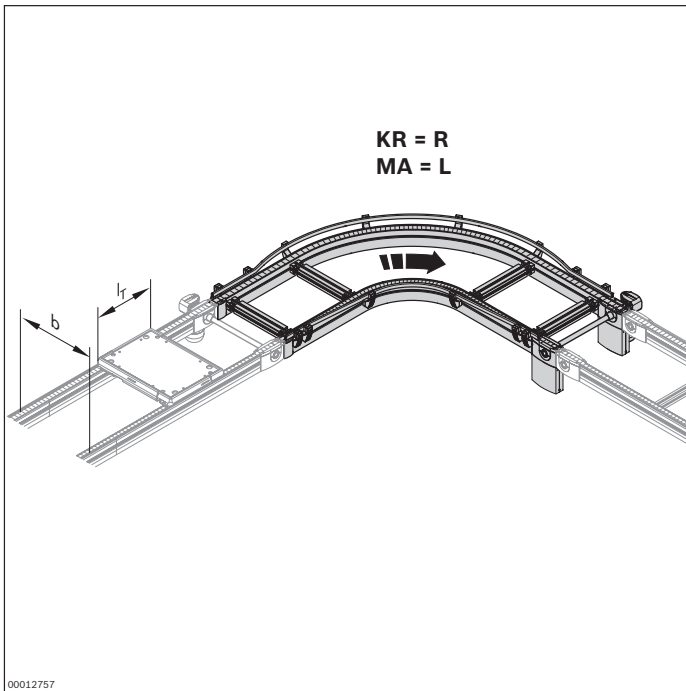

Material number		3842998098
b (mm)	Track width in direction of transport	160; 240; 320; 400; 480; 640; 800
l _T (mm)	Length in direction of transport	160; 240; 320; 400; 480; 640; 800; 1040
w x l _T (mm x mm)	Combination options	160 x 160; 240; 320 240 x 160; 240; 320; 400 320 x 160; 240; 320; 400; 480 400 x 240; 320; 400; 480; 640 480 x 320; 400; 480; 640; 800 640 x 400; 480; 640; 800; 1040 800 x 480; 640; 800; 1040
v _N (m/min)	Nominal speed	0; 6; 9; 12; 15; 18
U (V)	Voltage	See motor data, p. 11-24ff
f (Hz)	Frequency	See motor data, p. 11-24ff
AT	Motor connection S = cable/plug K = terminal box	S; K
MA	Motor mounting R = right L = left M = center ¹	R; L; M
KR	Curve direction R = right L = left	R; L

¹ MA = M only when b ≥ 240 mm

Technical data

Material number		3842998098
Load		
Max. section load in accumulation operation	kg	90
Features		
Max. operating temperature	T	°C
		+40 °C

Dimensions

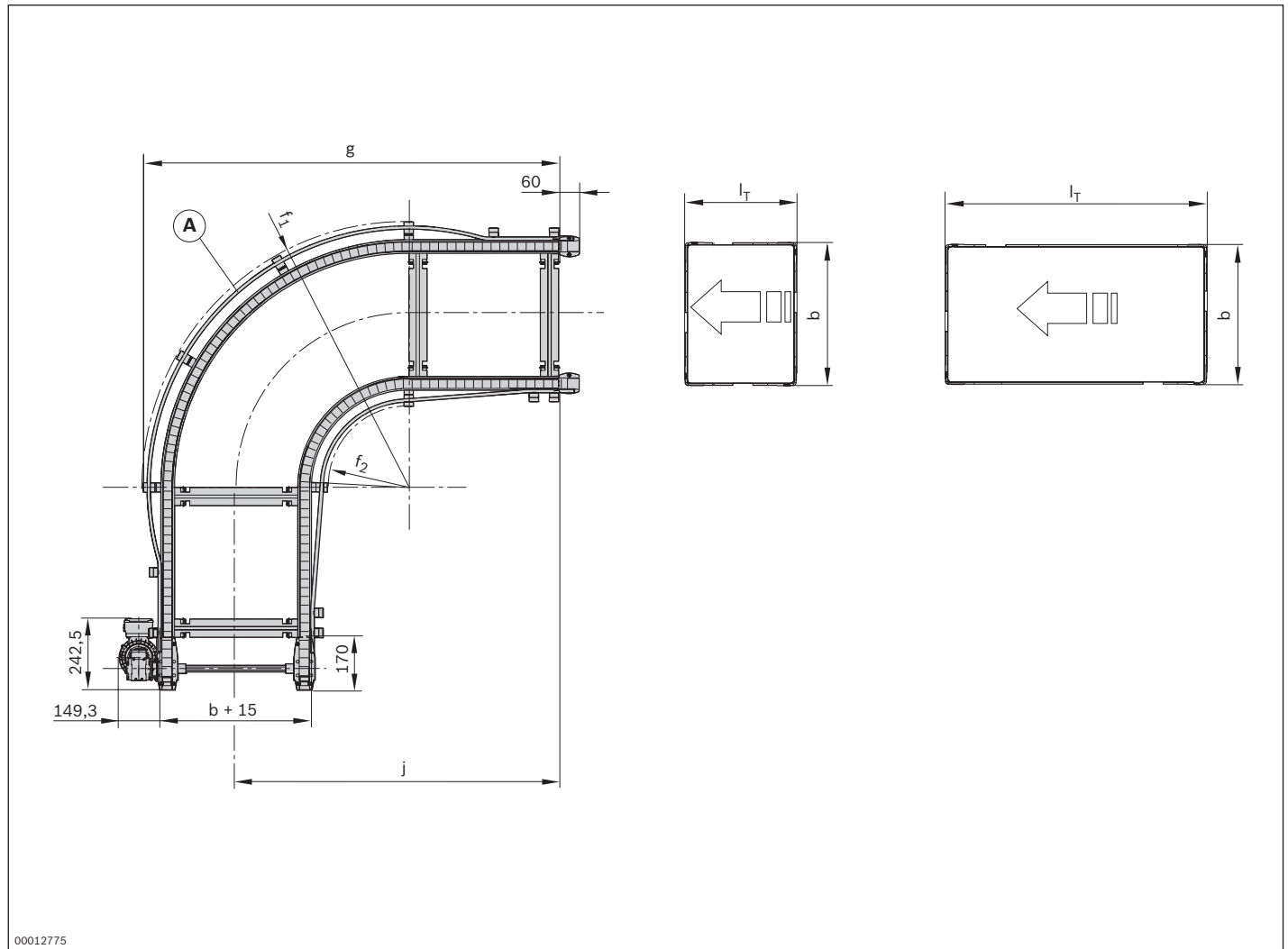

- Ⓐ Workpiece pallet outer guide from $l_T = 640$ mm
- b Track width in direction of transport

l_T Length in conveyor direction

Track width in direction of transport b (mm)	Length in direction of transport l _T (mm)	Curve radius f ₁ ¹ (mm)	Curve radius f ₂ ¹ (mm)	Dimension g (mm)	Dimension j (mm)
160	160	493	286	755	667
160	240	493	287	835	747
160	320	493	266	915	827
240	160	573	287	835	707
240	240	573	280	915	787
240	320	573	270	995	867
240	400	573	256	1075	947
240	480	573	240	1155	1027
320	160	653	288	915	747
320	240	653	282	995	827
320	320	653	273	1075	907
320	400	653	261	1155	987
320	480	653	247	1235	1067
400	240	733	283	1075	867
400	320	733	275	1155	947
400	400	733	265	1235	1027
400	480	733	252	1315	1107
400	640	770	260	1299	1032
480	320	813	277	1235	987
480	400	813	268	1315	1067
480	480	813	256	1395	1147
480	640	850	267	1366	1060
480	800	930	319	1695	1289
640	400	973	272	1475	1147
640	480	973	263	1555	1227
640	640	1010	278	1503	1117
640	800	1090	333	1733	1347
640	1040	1090	277	1973	1587
800	480	1133	267	1715	1307
800	640	1170	285	1642	1176
800	800	1250	344	1872	1406
800	1040	1250	296	2112	1646

¹f₁, f₂ = guideline value

KU 2/180 curve

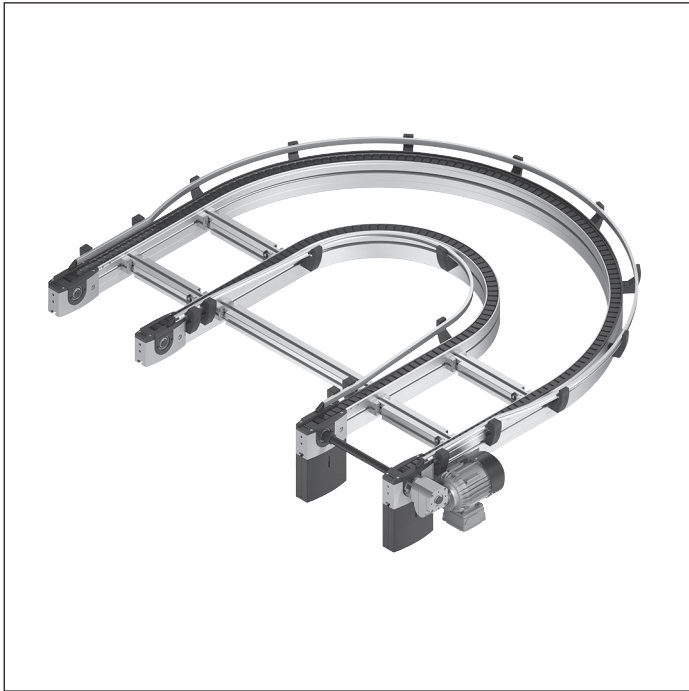

- ▶ 180° curve conveying of the workpiece pallet
- ▶ Curve with built-in drive
- ▶ Section loads up to 70 kg in accumulation operation
- ▶ Conveyor medium: Flat top chain
- ▶ Automatic chain tensioning system
- ▶ Plastic chain guides
- ▶ Accumulation operation possible
- ▶ Can be combined with WT 2, WT 2/F, WT 2/H and WT 2/F-H

Note:

- ▶ Flat top chain in ESD version is not permitted
- ▶ The LU 2 automatic lubrication unit is highly recommended for flat top chains:

The KU 2 curves with flat top chain conveyor medium have a built-in drive. They are suitable for use with high section loads in accumulation operation.

Accessories

Recommended accessories

- ▶ SZ 2 leg sets/..., see p. 6-2
- ▶ Accumulation pressure control, e.g., with WI/M rocker, see p. 8-133
- ▶ Connection kits, see p. 4-40
- ▶ LU 2 automatic lubrication unit, see p. 3-152

Delivery notes

Scope of delivery

- ▶ Curve, complete

Condition on delivery

- ▶ Fully assembled

Ordering information

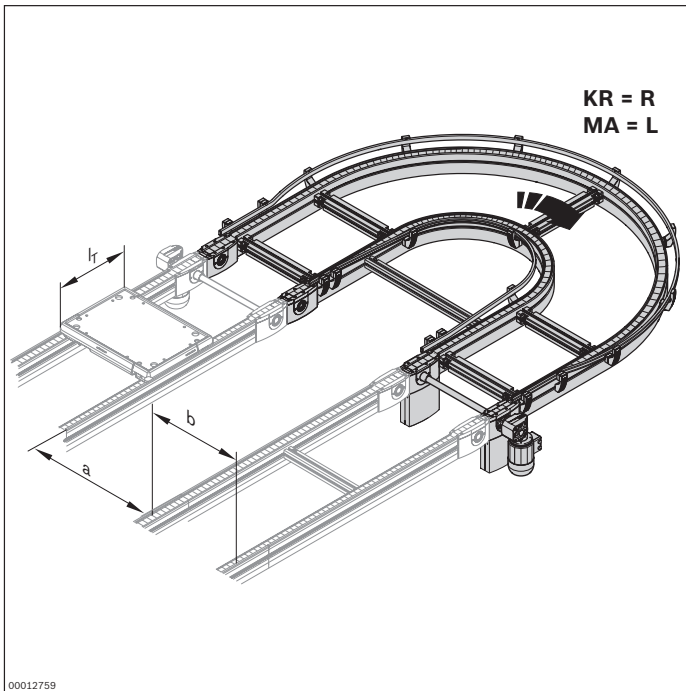

Material number		3842998099
b (mm)	Track width in direction of transport	160; 240; 320; 400; 480; 640; 800
l _T (mm)	Length in direction of transport	160; 240; 320; 400; 480; 640; 800; 1040
w x l _T (mm x mm)	Combination options a = 640 mm	b x l _T 160 x 160; 240; 320 240 x 160; 240; 320; 400 320 x 160; 240; 320; 400; 480 400 x 240; 320; 400; 480; 640 480 x 320; 400; 480; 640 640 x 400; 480; 640 800 x 480; 640
	a = 800 mm	480 x 800 640 x 800; 1040 800 x 800; 1040
v _N (m/min)	Nominal speed	0; 6; 9; 12; 15; 18
U (V)	Voltage	See motor data, p. 11-24ff
f (Hz)	Frequency	See motor data, p. 11-24ff
AT	Motor connection S = cable/plug K = terminal box	S; K
MA	Motor mounting R = right L = left M = center ¹	R; L; M
KR	Curve direction R = right L = left	R; L

¹ MA = M only when b ≥ 240 mm

Technical data

Material number		3842998099
Load		
Max. section load in accumulation operation	kg	70
Features		
Max. operating temperature	T	°C +40 °C

Dimensions

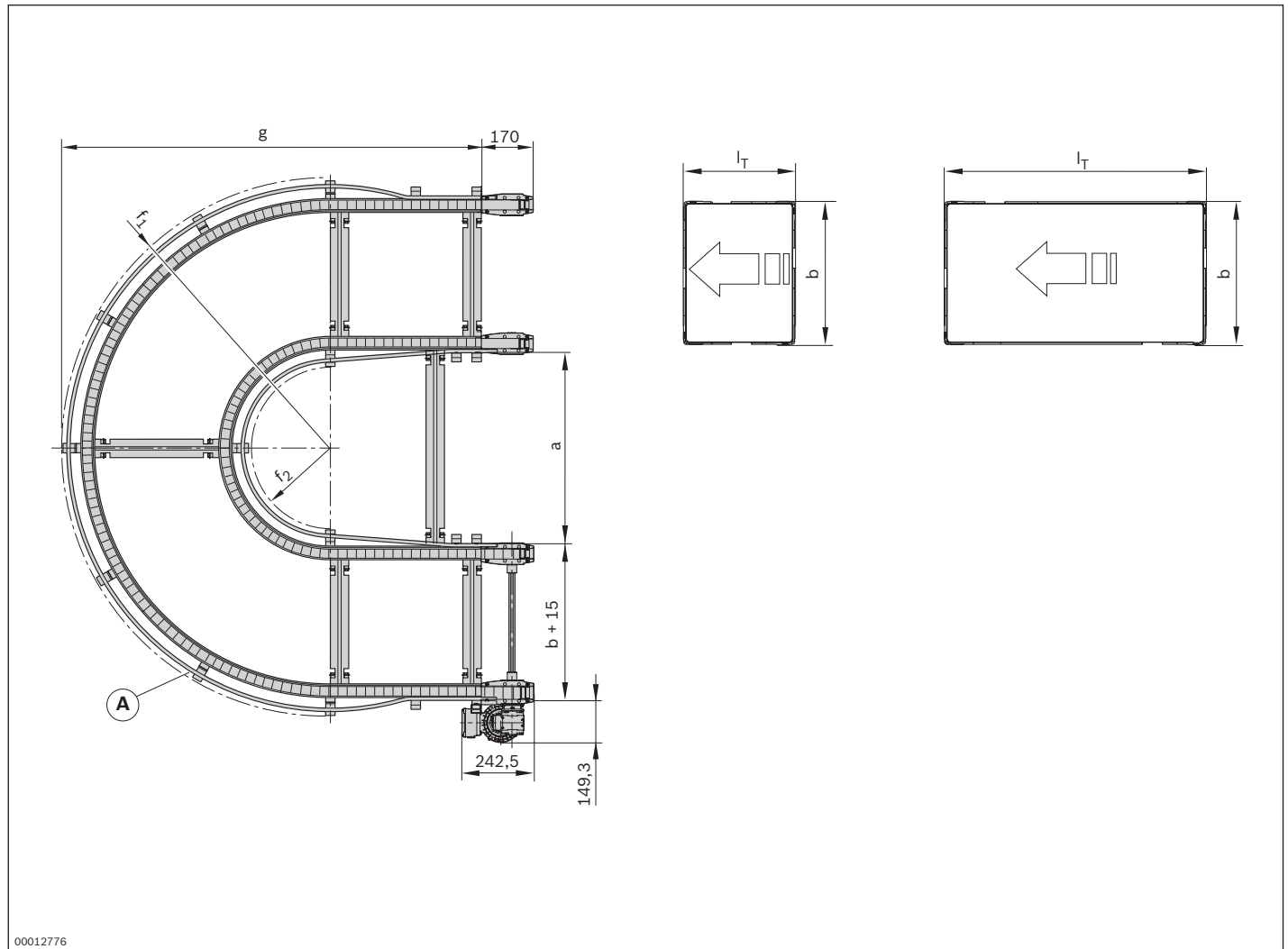

- Ⓐ Workpiece pallet outer guide from $l_T = 640$ mm
- b Track width in direction of transport

l_T Length in conveyor direction

Track width in direction of transport b (mm)	Length in direction of transport l _T (mm)	Curve radius f ₁ [†] (mm)	Curve radius f ₂ [†] (mm)	Dimension g (mm)	Distance between conveyors a (mm)
160	160	493	286	755	640
160	240	493	287	835	640
160	320	493	266	915	640
240	160	573	287	835	640
240	240	573	280	915	640
240	320	573	270	995	640
240	400	573	256	1075	640
240	480	573	240	1155	640
320	160	653	288	915	640
320	240	653	282	995	640
320	320	653	273	1075	640
320	400	653	261	1155	640
320	480	653	247	1235	640
400	240	733	283	1075	640
400	320	733	275	1155	640
400	400	733	265	1235	640
400	480	733	252	1315	640
400	640	770	260	1299	640
480	320	813	277	1235	640
480	400	813	268	1315	640
480	480	813	256	1395	640
480	640	850	267	1366	640
480	800	930	319	1595	800
640	400	973	272	1475	640
640	480	973	263	1555	640
640	640	1010	278	1503	640
640	800	1090	333	1733	800
640	1040	1090	277	1973	800
800	480	1133	267	1715	640
800	640	1170	285	1642	640
800	800	1250	344	1872	800
800	1040	1250	296	2112	800

†f₁, f₂ = guideline value