

Static friction chain

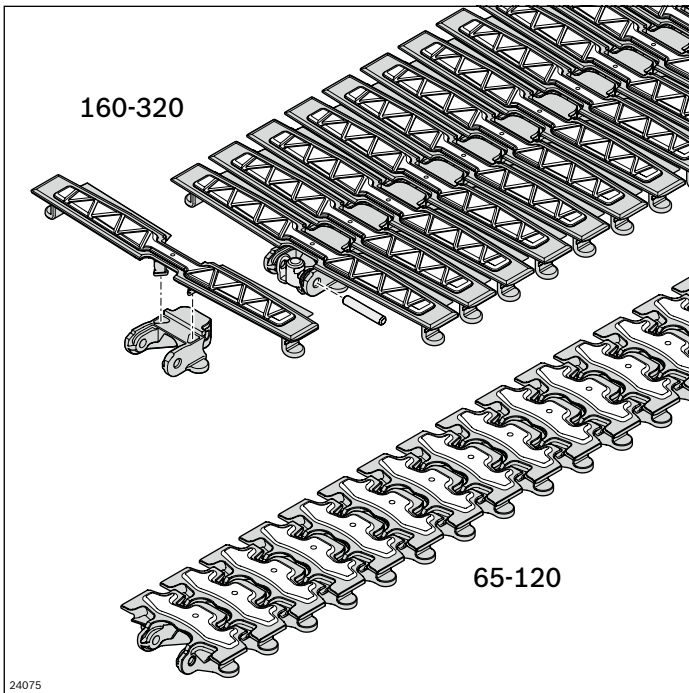

The static friction chain enables the transport of products on ascending or descending sections.

The number of chain links with static friction lining can be specified by the user depending on the product size, weight and the inclination.

- Transport possible on ascending or descending sections up to approx. 30°. Maximum gradient depends on the product surface, section length, and speed (test required)
- Accumulation operation not permitted
- Maximum chain tensile force: 1250 N
- From size 160: Chain plate easy to replace
- Only suitable for dry operation
- $AZ \geq 2$: Static friction chain supplemented with flat chain links ($AZ =$ spacing distance) $AZ = 1$: all links with static friction lining
- The grip is maintained through regular cleaning
- The chain coating is not suited to transporting sharp-edged objects

- ▶ Extremely quiet chain running thanks to the patented chain design
- ▶ Materials meet the requirements of EU 10/2011 and FDA CFR 21

- ▶ Large-area static friction lining for secure product transport

Required accessories for individual chain links:

Chain pin and jointed bolts, see page 23

For basic chain links 160-320, a chain plate is also required, see p. 20

Scope of delivery:

Chain: Complete, incl. chain pin and jointed bolts

Condition on delivery:

Chain: Fully assembled

Material:

- Chain link: POM
- Static friction coating: TPE Shore 70A
- Chain pin: Stainless steel, 1.4301
- Jointed bolts: PA66

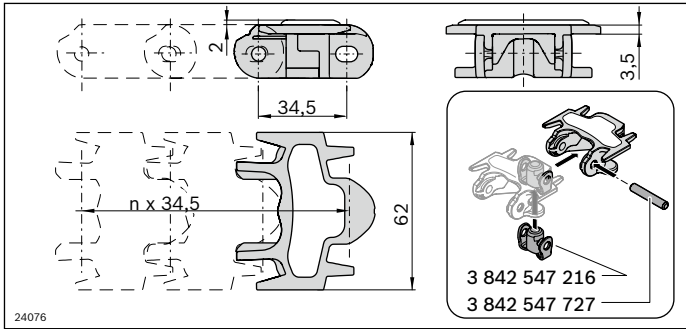

Static friction chain VFplus 65	L (mm)	No.
Conveyor chain; AZ = 1	4968	1 3 842 546 077
Conveyor chain; AZ = 2 ... 84	2898	1 3 842 998 706/AZ
Chain link	10	3 842 546 006
Chain pin	100	3 842 547 727
Swivel pin	100	3 842 547 216

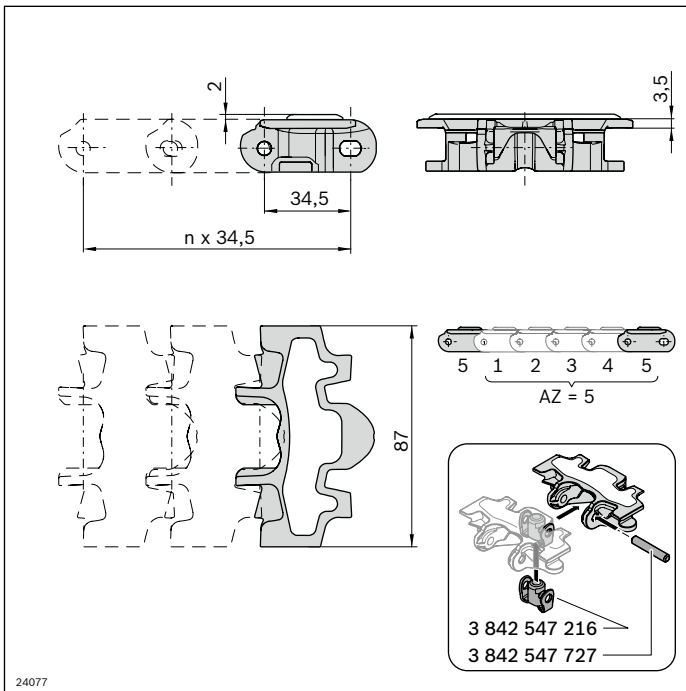

Static friction chain VFplus 90	L (mm)	No.
Conveyor chain; AZ = 1	4968	1 3 842 546 078
Conveyor chain; AZ = 2 ... 84	2898	1 3 842 998 707/AZ
Chain link	10	3 842 546 007
Chain pin	100	3 842 547 727
Swivel pin	100	3 842 547 216

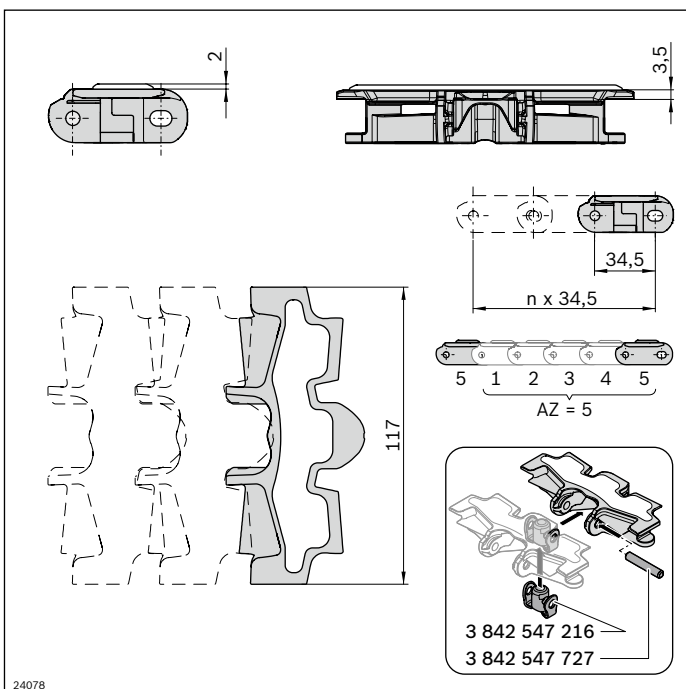

Static friction chain VFplus 120	L (mm)	No.
Conveyor chain; AZ = 1	4968	1 3 842 546 079
Conveyor chain; AZ = 2 ... 84	2898	1 3 842 998 708/AZ
Chain link	10	3 842 546 008
Chain pin	100	3 842 547 727
Swivel pin	100	3 842 547 216

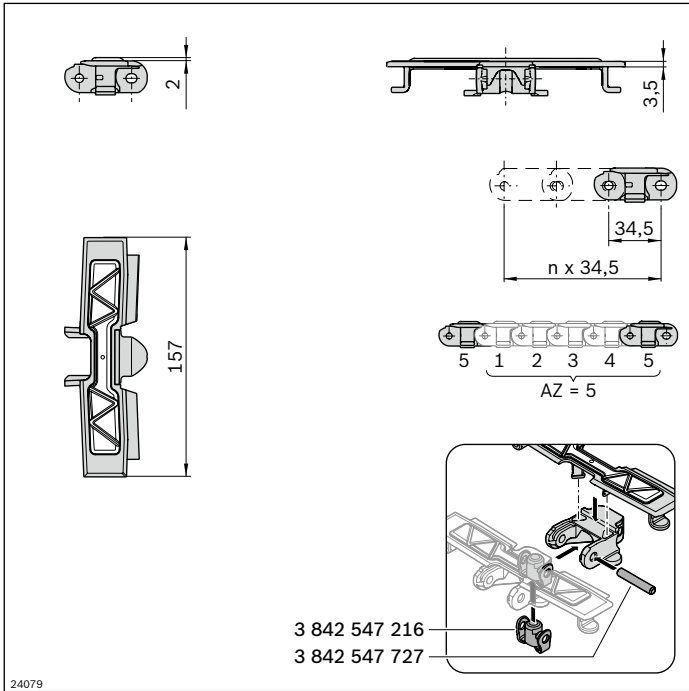

Static friction chain VFplus 160	L (mm)		No.
Conveyor chain; AZ = 1	2898	1	3 842 546 080
Conveyor chain; AZ = 2 ... 84	2898	1	3 842 998 709/AZ
Basic chain link 160-320		10	3 842 546 028
Chain plate 160		10	3 842 546 096
Chain pin		100	3 842 547 727
Swivel pin		100	3 842 547 216

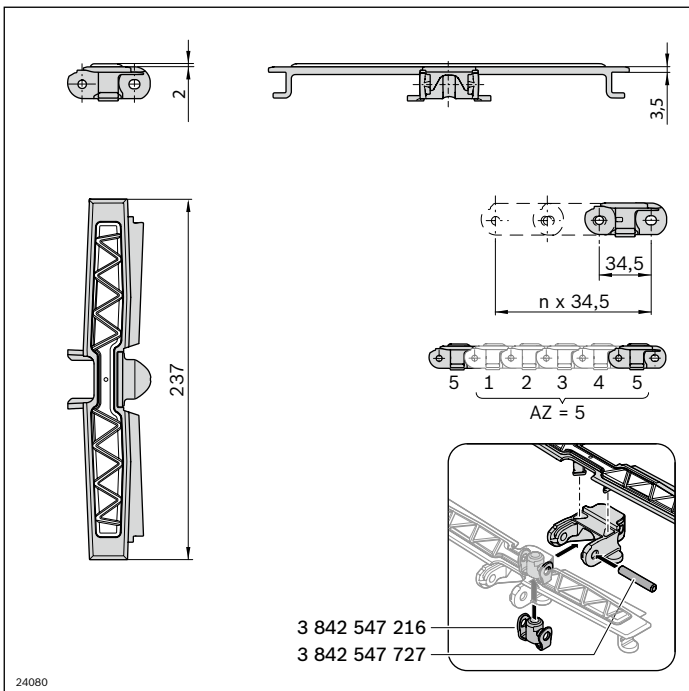

Static friction chain VFplus 240	L (mm)		No.
Conveyor chain; AZ = 1	2898	1	3 842 546 081
Conveyor chain; AZ = 2 ... 84	2898	1	3 842 998 710/AZ
Basic chain link 160-320		10	3 842 546 028
Chain plate 240		10	3 842 546 097
Chain pin		100	3 842 547 727
Swivel pin		100	3 842 547 216

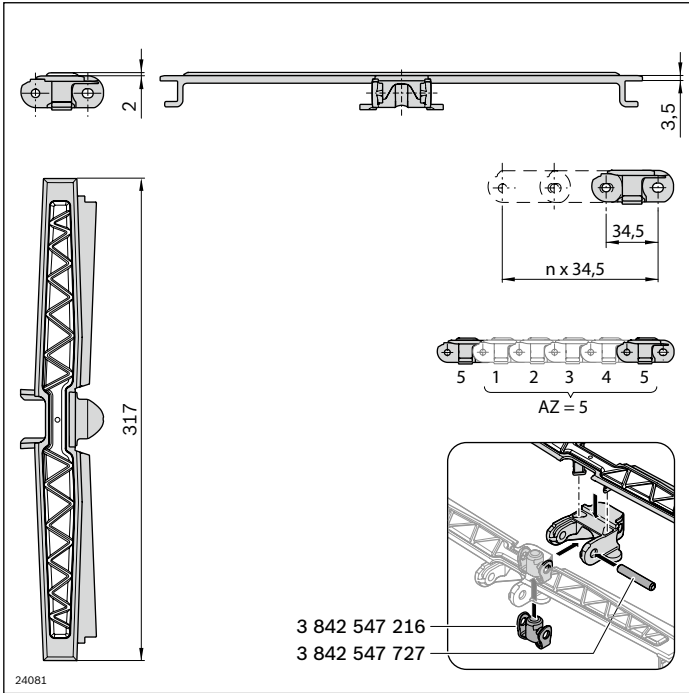

Static friction chain VFplus 320	L (mm)		No.
Conveyor chain; AZ = 1	2898	1	3 842 546 082
Conveyor chain; AZ = 2 ... 84	2898	1	3 842 998 711/AZ
Basic chain link 160-320		10	3 842 546 028
Chain plate 320		10	3 842 546 098
Chain pin		100	3 842 547 727
Swivel pin		100	3 842 547 216