

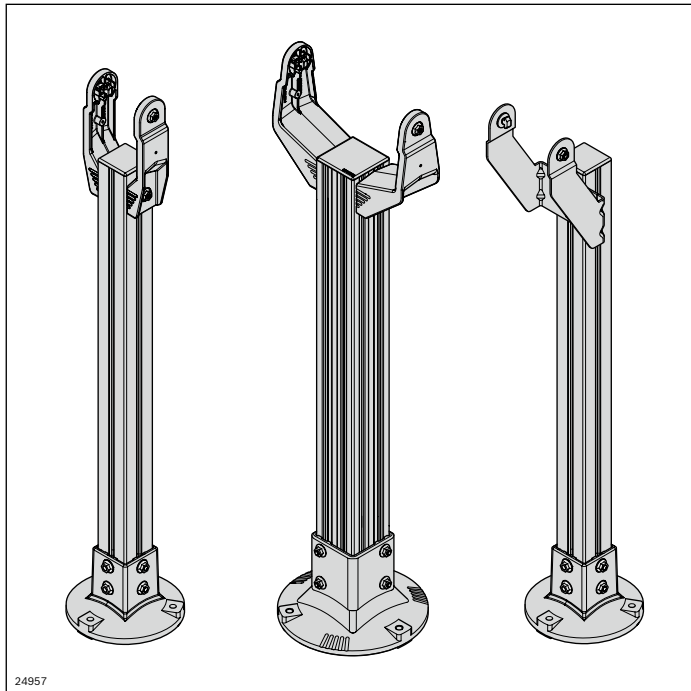

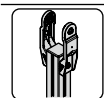

AL leg sets

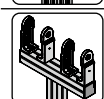

- ▶ Plug-through screws, few screwed connections
- ▶ Easy to clean thanks to ample draining surfaces
- ▶ Simple realization of ascending and descending conveyor sections thanks to a holder with centering lugs that can be broken off
- ▶ Drill guide for simple fastening of drip trays, safety devices, etc.
- ▶ Supports can also be used in conjunction with STS sections

Fast, simple leg set adjustment thanks to clever product details

	AL leg set 65-120	110
	AL leg set 160-320	114
	Supporting bracket AL	116
	Supporting bracket, lateral AL	118

AL leg set 65-120

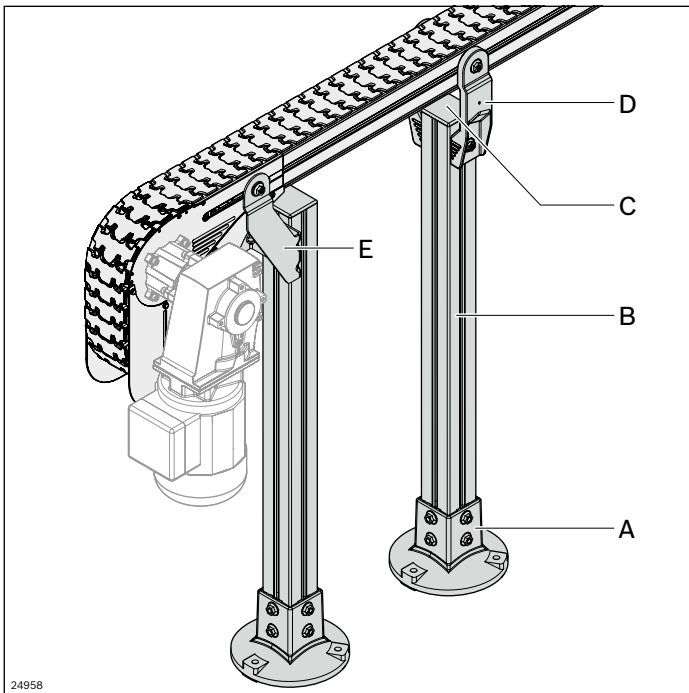

- ▶ Holder is easily centered in the slot thanks to centering lugs (**D**)
- ▶ Very simple assembly with plug-in screw connection (**D**)
- ▶ Easy-to-clean design with draining surfaces

The chain conveyor is placed on the ground by means of supports (and fastened) or even suspended from the ceiling. The suspension needs to be determined depending on the application.

The floor supports for sizes 65, 90 and 120 are constructed from the following single parts:

Foot 60x60 (**A**), strut profile 60x60 (**B**), cap (**C**), holder for attaching the section profiles (**D**) 65, 90 or 120.

A separate holder (**E**) is used to support the motors / drives.

- Depending on the speed, accumulation behavior and weight, the supports are to be fixed at a distance of approx. 2 ... 3 m
- The leg sets for the stainless steel system (see p. 168) may also be used for the aluminum system
- The holder (**E**) may only be used for AL systems
- The height adjustment range is up to 79 mm (**D**), depending on the return chain, see “Holder adjustment range” page 112
- The holder (**D**) can also be used for ascending and descending conveyor sections (up to 45°, depending on the return chain) by removing the centering lugs
- Holder (**D**) with drill guide for additional holes to fasten drip trays, trap guards for return chains, etc.

See also Setting up the supports for ESD systems, page 186.

Optional accessories:

Dowel, washer, see p. 112

Alternative feet (see Basic Mechanic Elements catalog, “Feet and wheels” section)

Scope of delivery:

- **A, E:** Incl. fastening material
- **D:** Set (2 pieces) incl. fastening material

Condition on delivery:

Not assembled

Material:

- **A, D:** diecast aluminum, silver
- **B:** aluminum; natural, anodized
- **C:** PA; black
- **E:** steel; galvanized

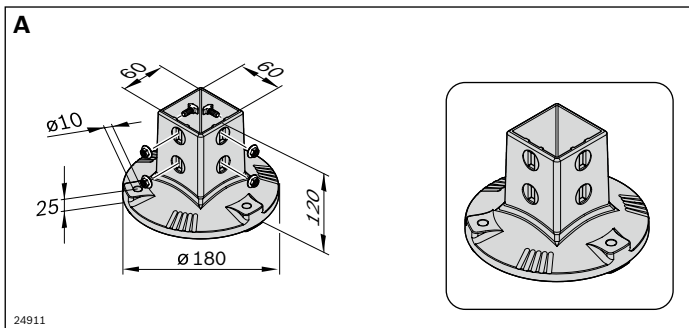

Foot, AL		No.
VFplus 60x60	1	3 842 544 875

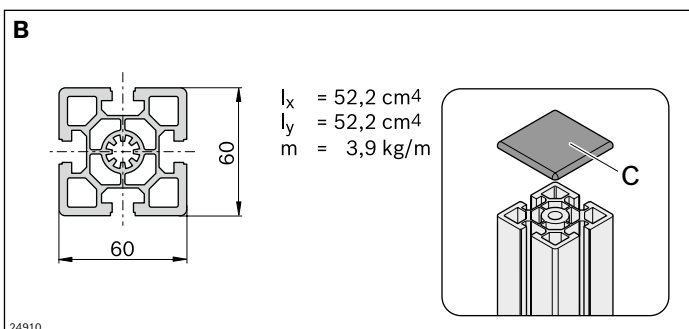

Strut profile AL 60x60	L (mm)	No.
20 pcs	6070	3 842 509 185
1 pcs	50 ... 5600	3 842 990 350/L

Cover cap	No.
VFplus 60x60, black	100 3 842 511 874

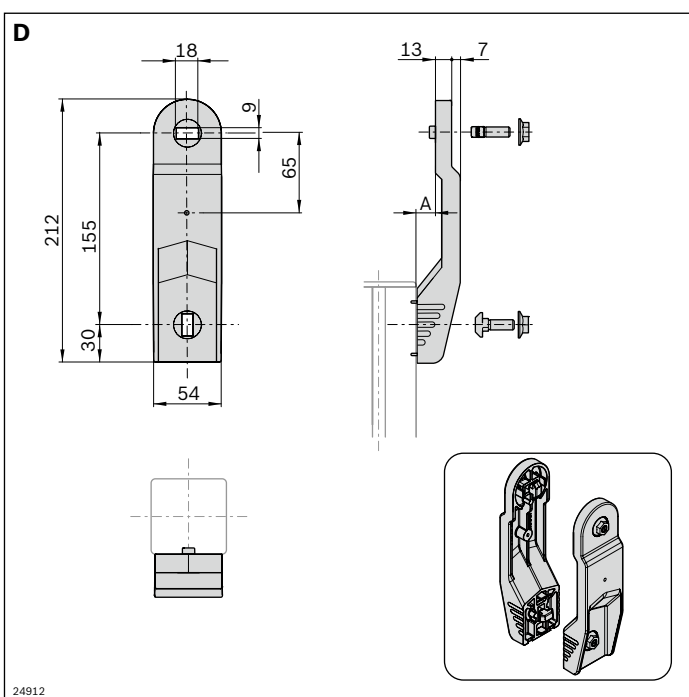

Holder AL	b (mm)	A (mm)	No.
VFplus 65	65	2.5	Set 3 842 546 625
VFplus 90	90	15	Set 3 842 546 626
VFplus 120	120	30	Set 3 842 546 627

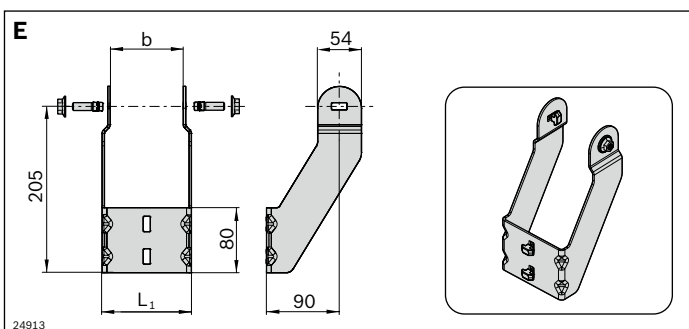

Holder motor leg sets AL	b (mm)	L ₁ (mm)	No.
VFplus 65	65	85	Set 3 842 547 442
VFplus 90	90	110	Set 3 842 547 443
VFplus 120	120	140	Set 3 842 547 444

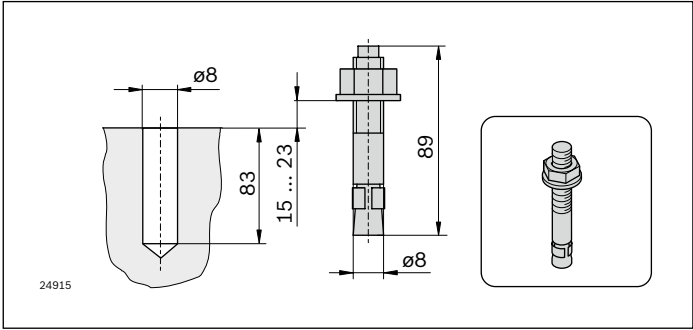

Dowel		No.
	100	3 842 540 668

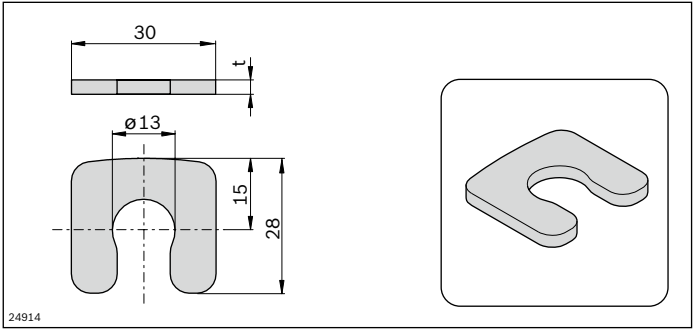

Washer	t (mm)		No.
	1	100	3 842 546 717
	3	20	3 842 546 718

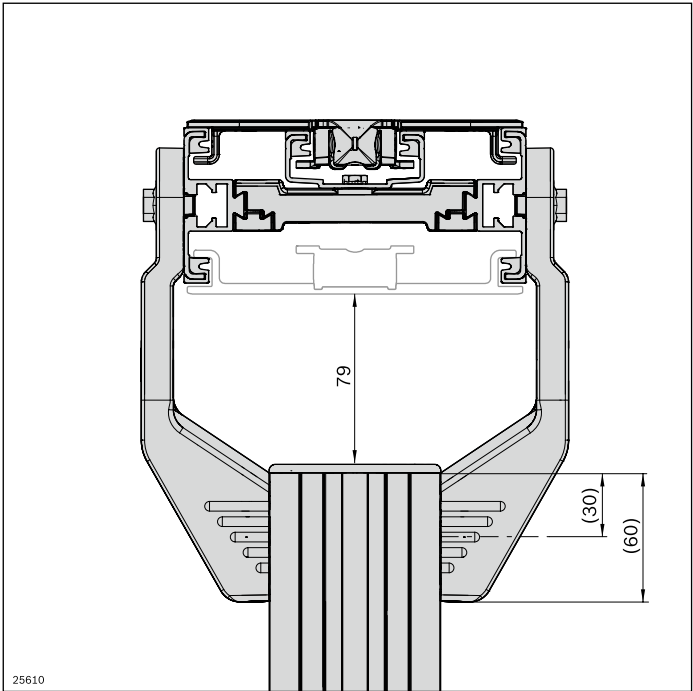

Holder adjustment range

The aluminum holder adjustment range shown relates to the standard installation position (holder flush with the profile end) and the use of a flat chain for horizontal running of the chain. For vertical use, the adjustment range is reduced depending on the angle.

Curve wheel drive support



3

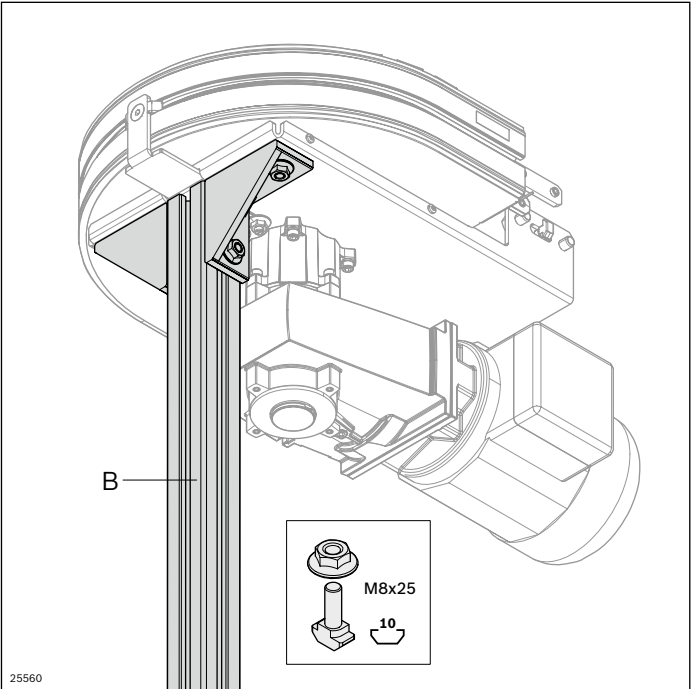

Bracket 40/80	Groove ESD		No.
Set (standard)	10 / 10		1 3 842 529 386
designLINE set	10 / 10		1 3 842 538 717

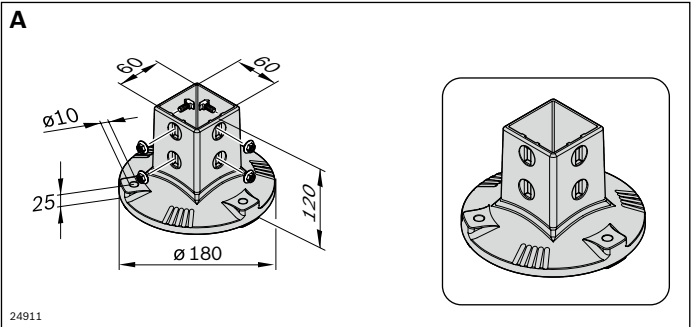

Foot, AL		No.
VFplus 60x60		1 3 842 544 875

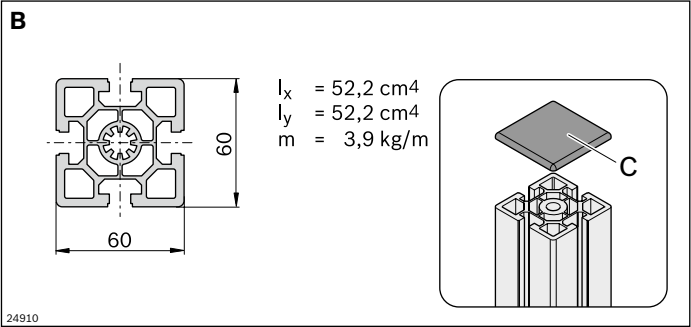

Strut profile AL 60x60	L (mm)	No.
20 pcs	6070	3 842 509 185
1 pcs	50 ... 5600	3 842 990 350/L

Cover cap		No.
VFplus 60x60, black		100 3 842 511 874

AL leg set 160-320

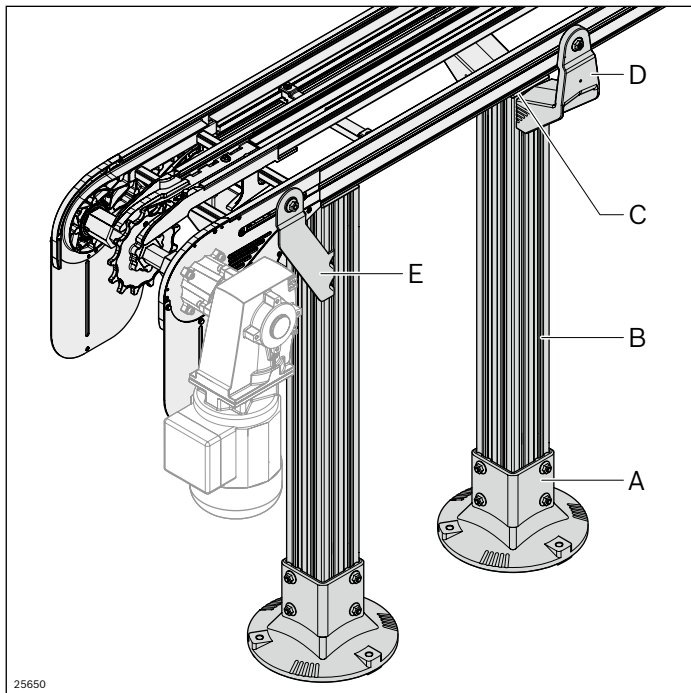

- ▶ Holder is easily centered in the slot thanks to centering lugs (**D**)
- ▶ Very simple assembly with plug-in screw connection (**D**)
- ▶ Easy-to-clean design with draining surfaces

Optional accessories:

Dowel, washer, see p. 112

Alternative feet (see Basic Mechanic Elements catalog, "Feet and wheels" section)

Scope of delivery:

- **A, E**: Incl. fastening material
- **D**: Set (2 pieces) incl. fastening material

The chain conveyor is placed on the ground by means of supports (and fastened) or even suspended from the ceiling. The suspension needs to be determined depending on the application.

The floor supports for sizes 160, 240 and 320 are constructed from the following single parts:

Foot 80x80 (**A**), strut profile 80x80L (**B**), cap (**C**), holder for attaching the section profiles (**D**) 160, 240 or 320.

A separate holder (**E**) is used to support the motors / drives

- Depending on the speed, accumulation behavior and weight, the supports are to be fixed at a distance of approx. 2 ... 3 m
- The leg sets for the stainless steel system (see p. 168) may also be used for the aluminum system
- The holder (**E**) may only be used for AL systems
- The height adjustment range is up to 79 mm (**D**), depending on the return chain, see p. 112
- The holder (**D**) can also be used for ascending and descending conveyor sections (up to 45°, depending on the return chain) by removing the centering lugs
- Holder (**D**) with drill guide for additional holes to fasten drip trays, trap guards for return chains, etc.

Condition on delivery:

Not assembled

Material:

- **A, D**: diecast aluminum, silver
- **B**: aluminum; natural, anodized
- **C**: PA; black
- **E**: steel; galvanized

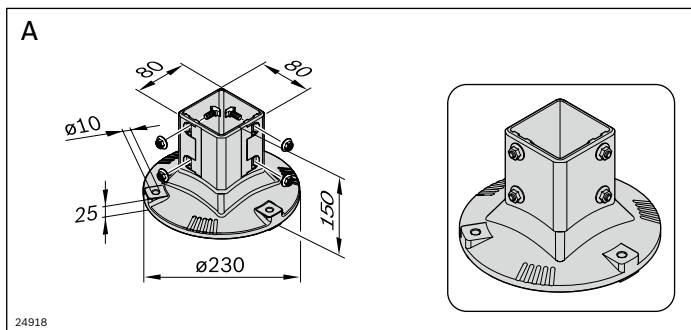

Foot, AL	No.
VFplus 80x80	1 3 842 540 173

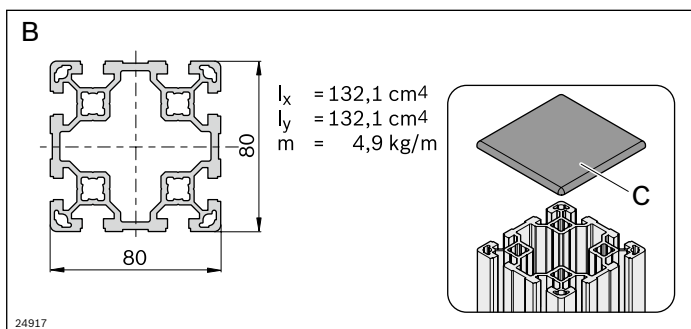

Strut profile AL 80x80 L	L (mm)	No.
6 pcs	6070	3 842 529 347
1 pcs	50 ... 6000	3 842 993 133/L

Cover cap	No.
VFplus 80x80, black	20 3 842 529 039

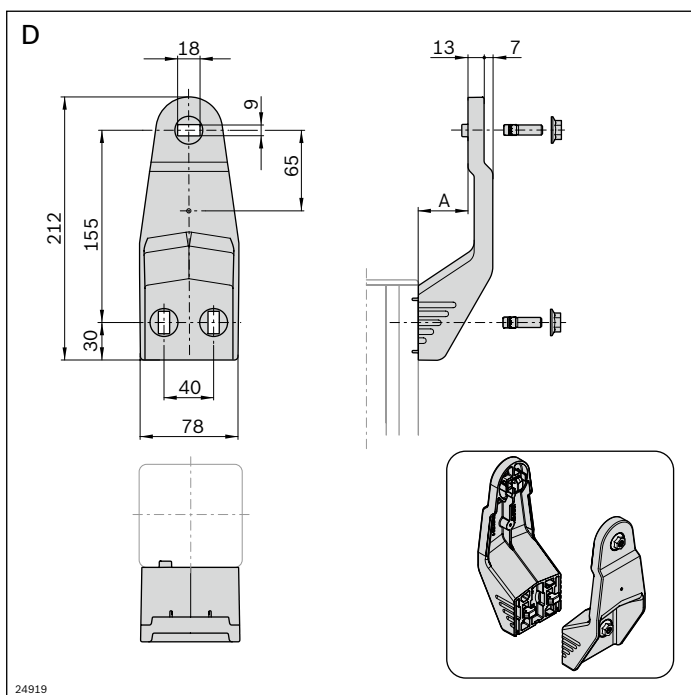

Holder AL	b (mm)	A (mm)	No.
VFplus 160	160	40	Set 3 842 546 628
VFplus 240	240	80	Set 3 842 546 629
VFplus 320	320	120	Set 3 842 546 630

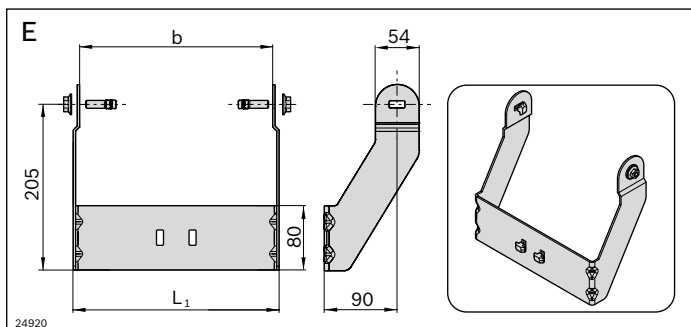

Holder engine support AL	b (mm)	L ₁ (mm)	No.
VFplus 160	160	180	Set 3 842 547 445
VFplus 240	240	260	Set 3 842 547 446
VFplus 320	320	340	Set 3 842 547 447

Supporting bracket AL

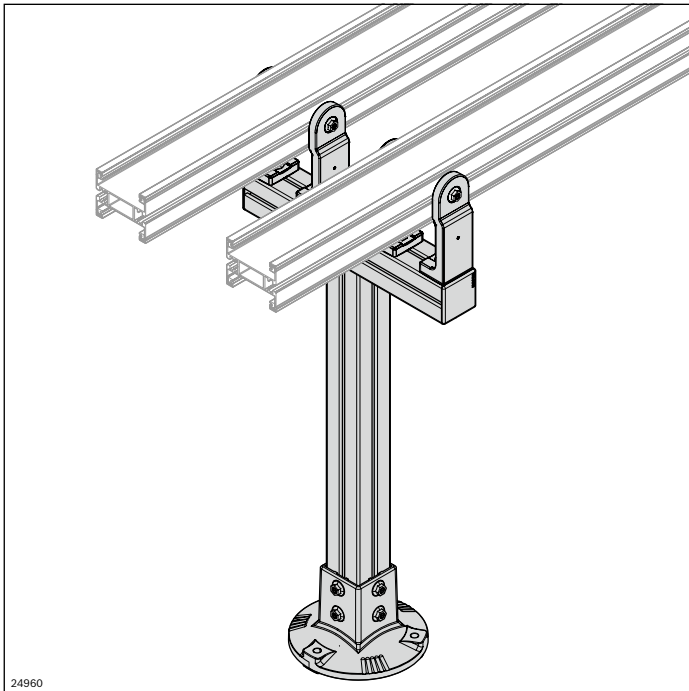

The supporting bracket allows several parallel sections to be mounted on a horizontal profile.

- The distance between the supporting brackets is to be approx. 2-3 m, depending on the speed, accumulation behavior and weight
- The supporting brackets can also be used for ascending and descending conveyor sections (up to 45°, depending on the returning chain) by removing the centering lugs

- Simple centering of the supporting brackets in the slot thanks to centering lugs
- Very simple assembly with plug-in screw connections
- Easy-to-clean design with draining surfaces

Scope of delivery:

Incl. fastening material

Material:

diecast aluminum, silver

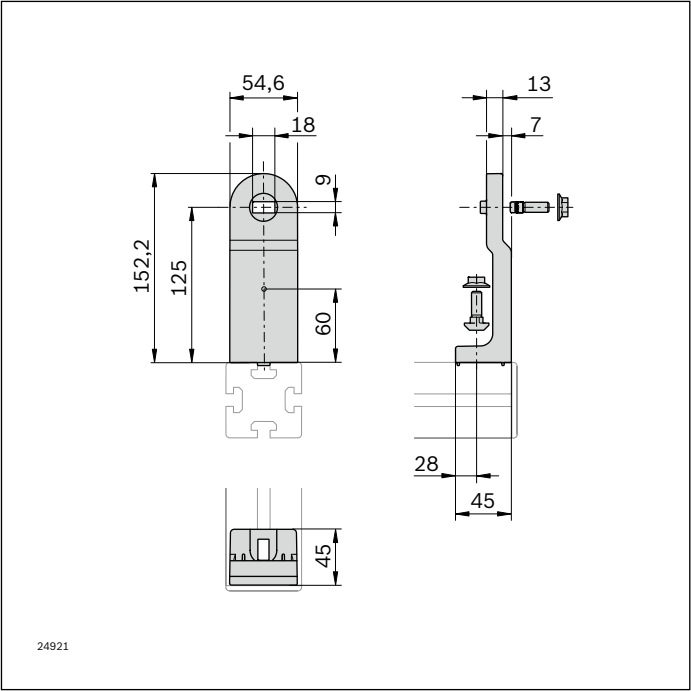

Supporting bracket VFplus AL		No.
Set		3 842 546 632

Supporting bracket, lateral AL

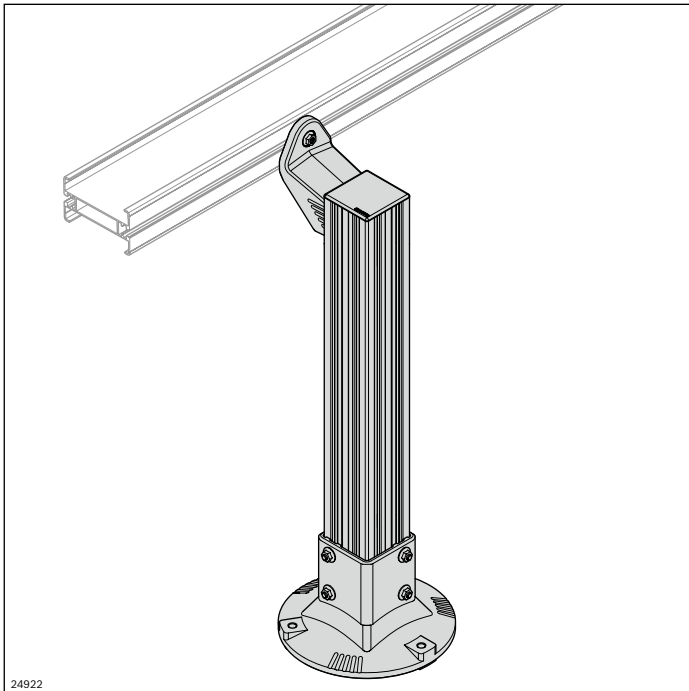

The lateral supporting bracket is provided for the attachment to an 80x80 vertical strut profile. It is suitable for the construction of an alpine conveyor, for example.

- In the case of one-sided attachment, the lateral supporting bracket is only permissible for sizes up to 120
- The lateral supporting bracket can also be used for ascending and descending conveyor sections (up to 45°) by removing the centering lugs

- Simple centering of the supporting brackets in the slot thanks to centering lugs
- Very simple assembly with plug-in screw connections

- Easy-to-clean design with draining surfaces

Scope of delivery:

Incl. fastening material

Material:

diecast aluminum, silver

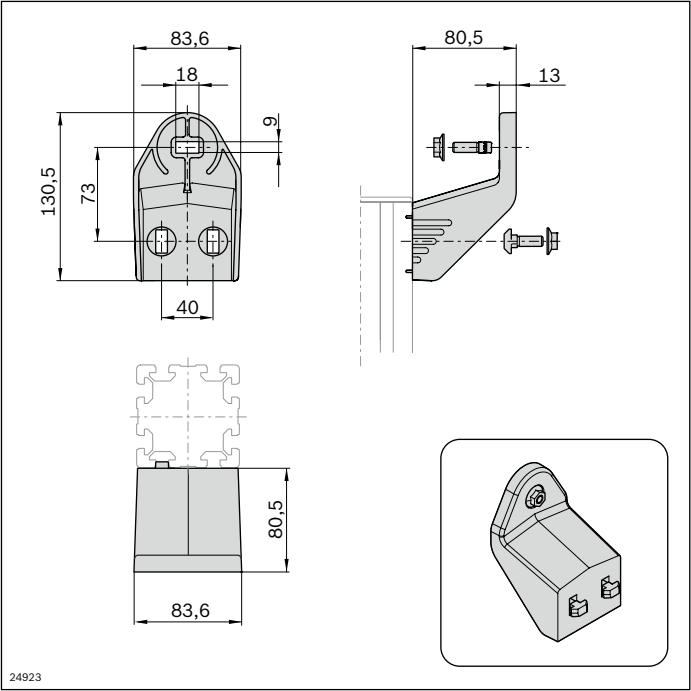

Supporting bracket VFplus lateral AL	No.
Set	3 842 547 461