

Pneumatically adjustable lateral guide

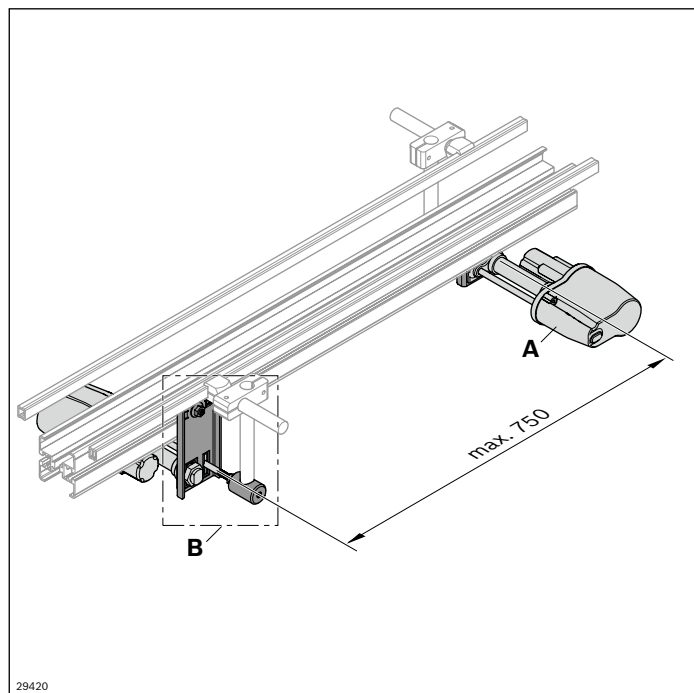

The complete lateral guide can be adapted to rapidly changing product dimensions, especially when the conveyors are not easily accessible. The pneumatically adjustable lateral guide is composed of the adjustment unit (**A**), the assembly kit (**B**) and components from the lateral guide program.

- Size: 65-320
- Max. pressure against the lateral guide (on one side): 30 N/700 mm
- Synchronous, balanced adjustment
- Adjustment by means of pneumatic valve (operating pressure 4 ... 5 bar, switching every 2 sec. (depending on length of the pneumatic pipes and the number of adjustment units per valve))
- Adjustment range for each side: 16 stroke à 2 mm = 32 mm, after 16 switching operations the adjustment unit returns to its initial position
- Maximum number of adjustment units per valve: 8 pcs
- Position monitoring by customer is recommended

► Mounting and adjustment mechanisms are placed under the conveyor system for easy accessibility of the transported material

► Mounting and adjustment also in horizontal and vertical curves. A customer-side adjustment is required for horizontal curves

Required accessories:

- Tube 18 mm (**W**), cross piece (**X**), clamping holder (**M,O**), profile rail (**A, B, C, D**) (see Lateral Guide chapter on page 198)
- One 4/2 directional control valve per 8 adjustment units

Scope of delivery:

B: Incl. fastening material

Condition on delivery:

A: Fully assembled

B: Not assembled

Material:

A: AL anodized, PE, steel, galvanized steel, PA

B: Galvanized steel, AL anodized

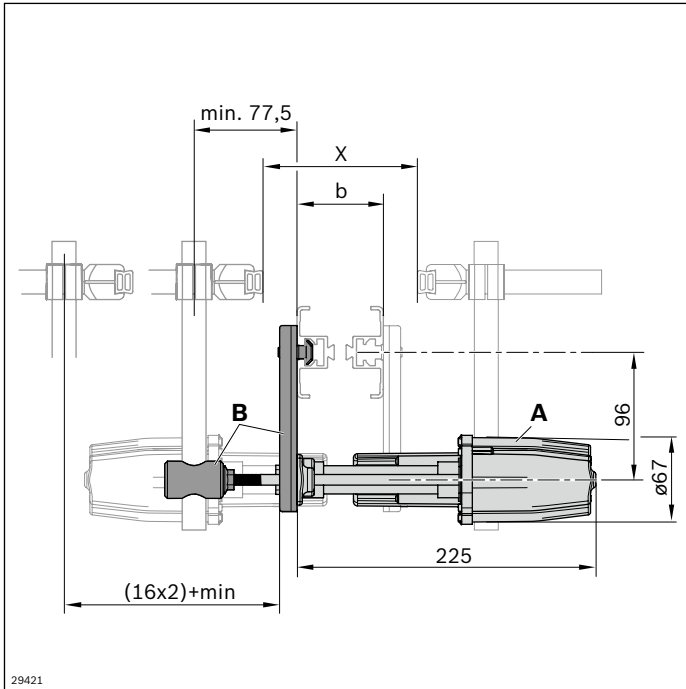

Adjustment unit	No.
A	3 842 547 707

Mounting kit	No.
B	3 842 547 718

Track width b	X min	X max
65	0	116
90	0	141
120	0	171
160	0	211
240	0	291
320	0	371