

19898

Conveyor track made of section profiles and roller elements

- ▶ Economical solution for manual slide sections
- ▶ Roller elements can be clipped in

Accessories:

Roller elements (p. 12-22)

SP 2/R

$A = 5,2 \text{ cm}^2$
 $I_x = 4,3 \text{ cm}^4$
 $I_y = 11,7 \text{ cm}^4$
 $W_x = 2,4 \text{ cm}^3$
 $W_y = 5,2 \text{ cm}^3$
 $m = 1,4 \text{ kg/m}$

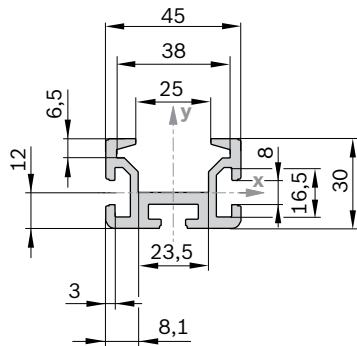

19893

Section profile SP 2/R	L (mm)	No.
	50 ... 6000	3 842 992 676 / L
Material: aluminum, natural-colored, anodized		

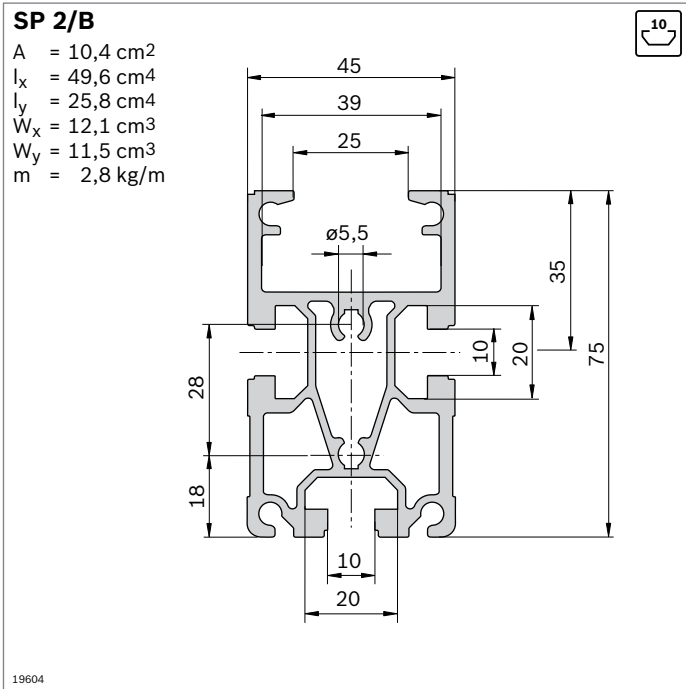

SP 2/B section profile		Slot	L (mm)	No.
1 pcs		10	200...6000	3 842 992 884 / L
16 pcs		10	6070	3 842 532 695

Material: aluminum, natural-colored, anodized
 Accessories: QV 2 cross connector, (s. 12-43)

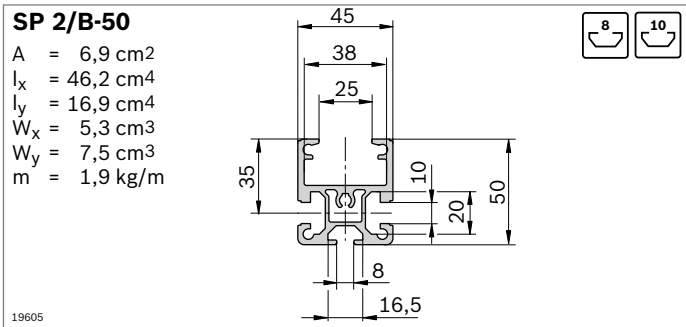

SP 2/B-50 section profile		Slot	L (mm)	No.
1 pcs		8 / 10	200...6000	3 842 992 903 / L
20 pcs		8 / 10	6070	3 842 532 697

Material: aluminum, natural-colored, anodized

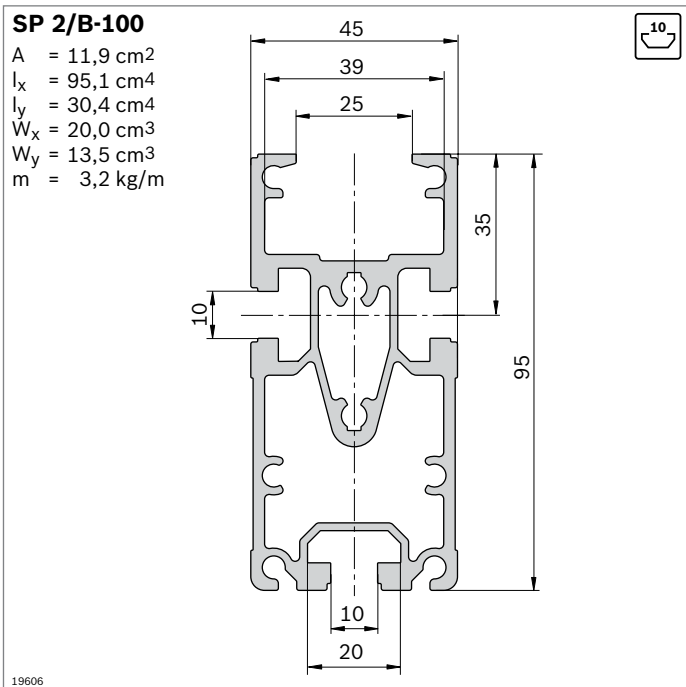

SP 2/B-100 section profile		Slot	L (mm)	No.
1 pcs			200...6000	3 842 993 259 / L
16 pcs		10	6070	3 842 532 608

Material: aluminum, natural-colored, anodized
 Accessories: QV 2 cross connector, (s. 12-43)

SP 2/BH

A = 12,4 cm²
 $I_x = 53,7 \text{ cm}^4$
 $I_y = 28,6 \text{ cm}^4$
 $W_x = 14,0 \text{ cm}^3$
 $W_y = 13,8 \text{ cm}^3$
 m = 3,3 kg/m

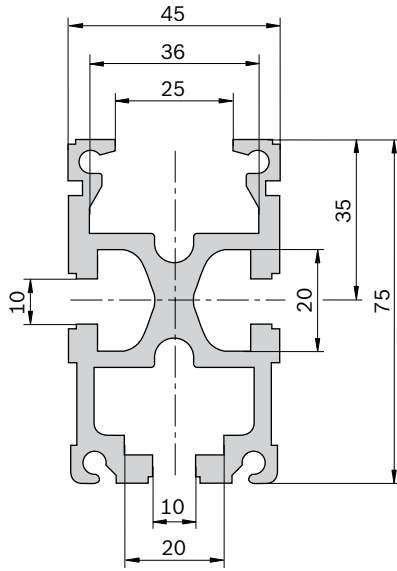

19607

Section Profile SP 2/BH	Slot	L (mm)	No.
1 pcs	10	200...6000	3 842 990 409 / L
16 pcs	10	6070	3 842 532 696

Material: aluminum, natural-colored, anodized

Accessories: QV 2 cross connector, (s. 12-43)

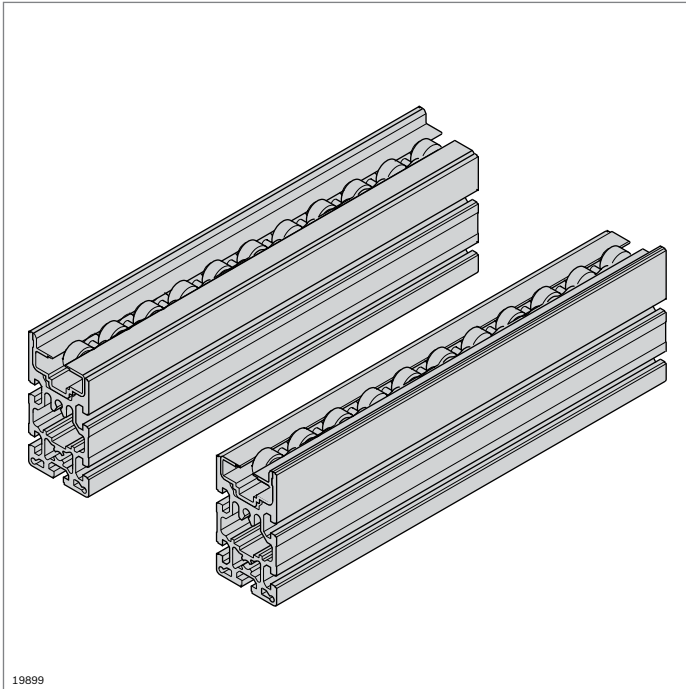

Conveyor sections made of SP 4/R section profiles and accumulation roller chains

- ▶ For constructing manual slide sections with high bearing loads (up to 2 kg/cm)
- ▶ For applications with and without workpiece pallets
- ▶ Low friction
- ▶ Steel chain with support wheels made of PA 12

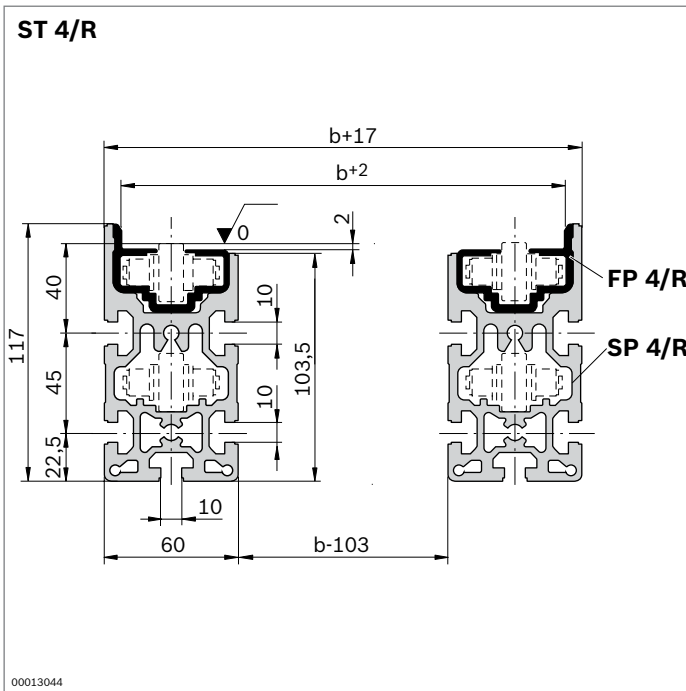

Section ST 4/R	L (mm)	No.
	200...6000	3 842 994 839 / L

Material: aluminum, natural-colored, anodized
 Guide profile: PA 12

Scope of delivery: 2 x section profile SP 4/R
 2 x guide profile FP 4/R

Condition on delivery: Fully assembled

Accessories: Accumulation roller chain (p. 12-39)
 QV 4 cross connector, (s. 12-39)

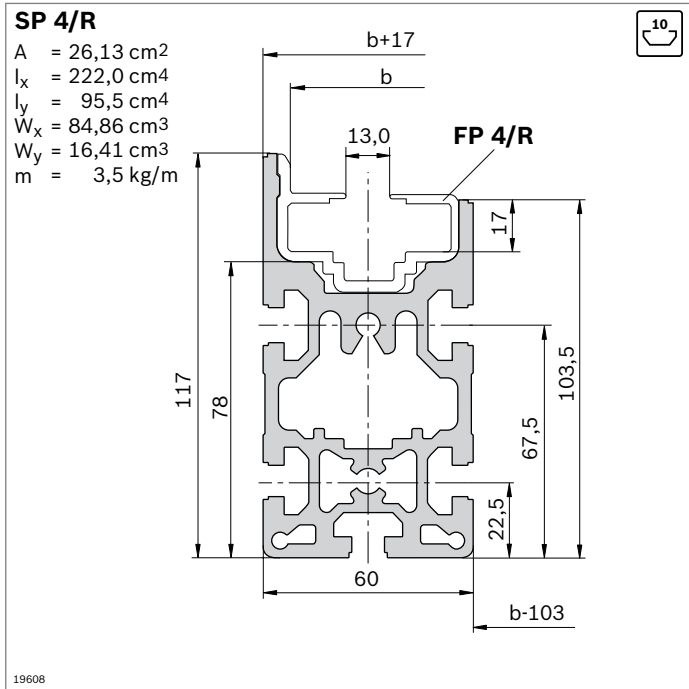

Section profile SP 4/R		L (mm)	No.
10 pcs		6000	3 842 532 505
Material:	aluminum, natural-colored, anodized		
Accessories:	Guide profile FP 4/R Accumulation roller chain (p. 12-39) QV 4 cross connector, (s. 12-39)		

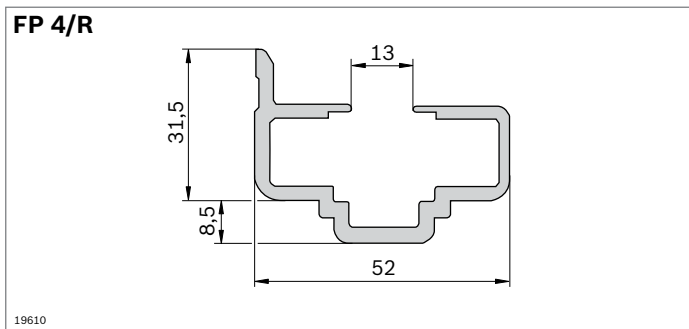

Guide profile FP 4/R		L (mm)	No.
10 pcs		6000	3 842 532 508
Material:	PA 12 (anti-static)		

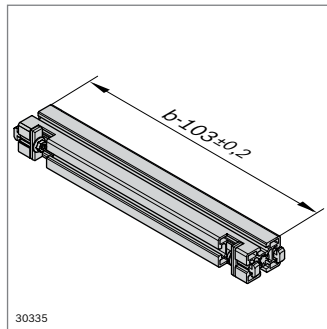
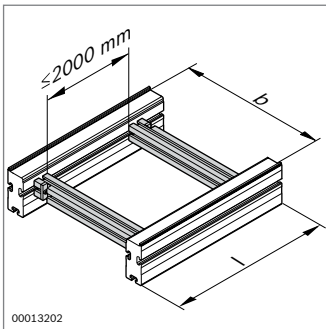
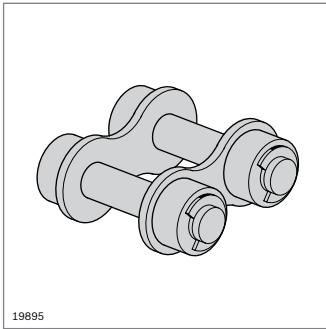
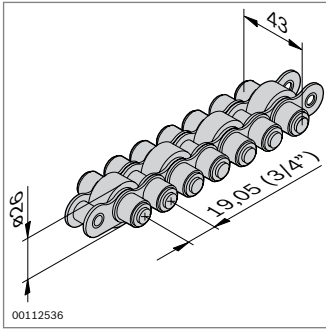

Accumulation roller chain	L (mm)	No.
Support wheel: PA 12	5000	3 842 508 967

Material: Accumulation roller chain: steel
 Support roller: see ordering table
 Scope of delivery: incl. chain coupling
 Accessories: additional chain coupling (**3 842 071 941**)

► Chain coupling for extending accumulation roller chains

Master link	No.
	3 842 071 941

Material: Steel

► Cross connector QV 4 for connecting two section profiles
 ► For defining the track width

QV 4 cross connector	b (mm)	No.
	443...1243	3 842 994 832 / b

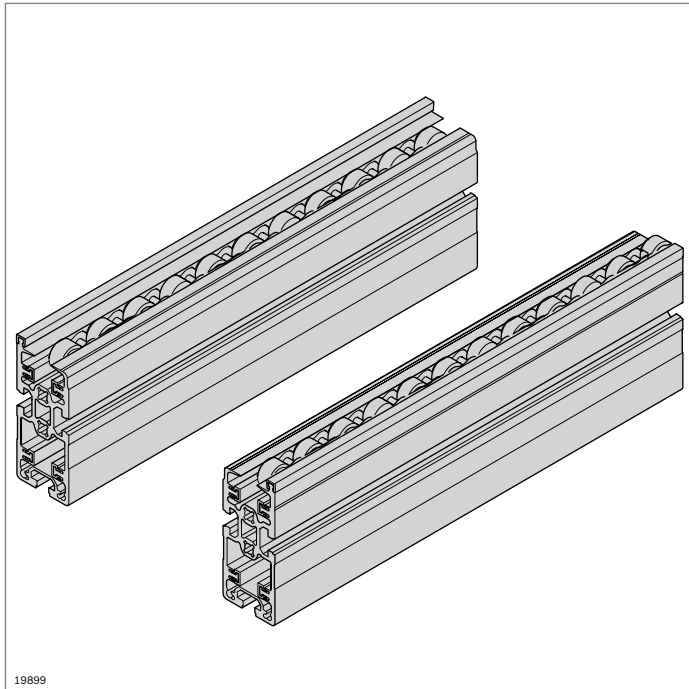

Conveyor sections made of SP 2 section profiles and accumulation roller chains

- ▶ For constructing manual slide sections with high bearing loads (up to 2.0 kg/cm)
- ▶ For applications with and without workpiece pallets
- ▶ Accumulation roller chain with and without small parts trap

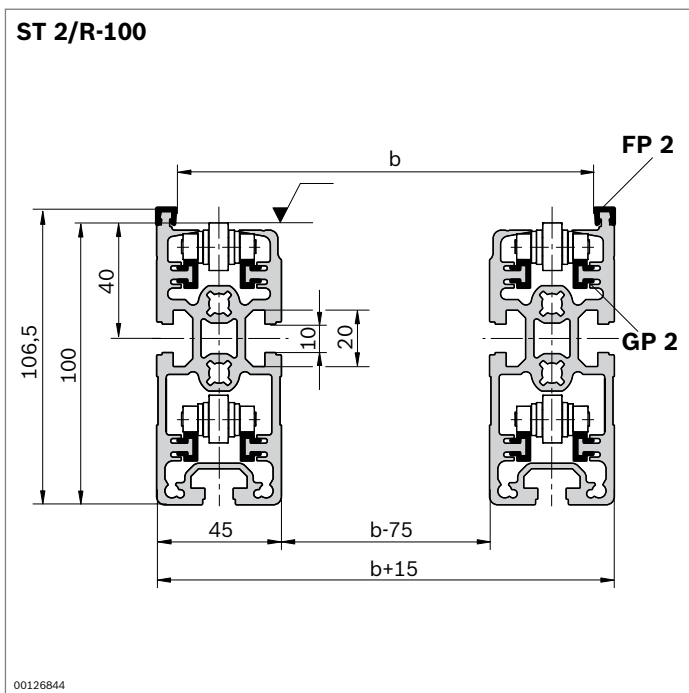

- ▶ Customizable section with plastic guide profile

Section ST 2/R-100	ESD	L (mm)	No.
		60 ... 6000	3 842 994 889 /L
Material:	aluminum, natural-colored, anodized Slide profile, guide profile: PA 12		
Scope of delivery:	2 x section profile SP 2/R-100 2 x guide profile FP 2 8 x slide profile GP 2		
Condition on delivery:	Fully assembled		
Accessories:	Accumulation roller chain (p. 12-43) Accumulation roller chain with small parts trap (p. 12-43) Cross connector QV 2, QV 2-H (p. 12-43)		

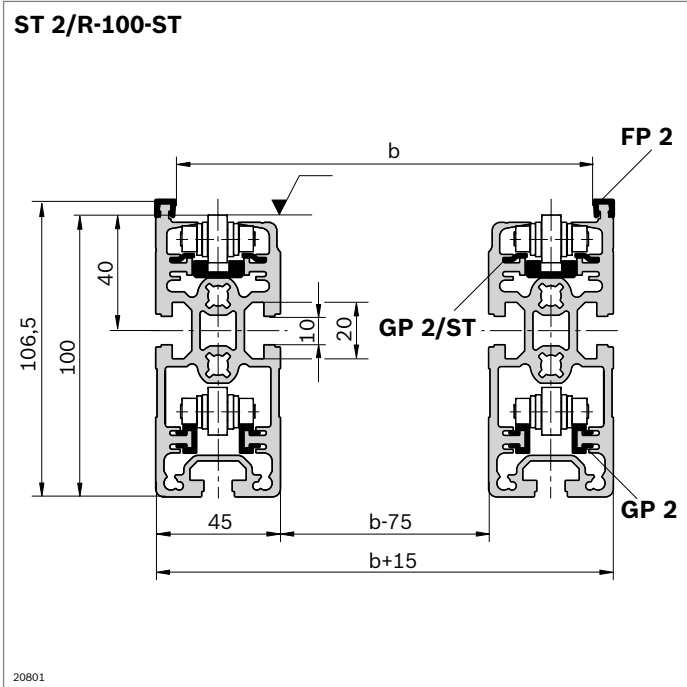

Section ST 2/R-100 ST	ESD	L (mm)	No.
		60 ... 6000	3 842 994 907 / L

Material: aluminum, natural-colored, anodized
 Slide profile: Steel
 Guide profile: PA 12
 Guide profile for accumulation roller chain: PE

Scope of delivery: 2 x section profile SP 2/R-100
 2 x guide profile FP 2
 4 x slide profile GP 2
 4 x slide profile GP 2/ST
 2 x guide profile for accumulation roller chain

Condition on delivery: Fully assembled

Accessories: Accumulation roller chain (p. 12-43)
 Accumulation roller chain with small parts trap (p. 12-43)
 Cross connector QV 2, QV 2-H (p. 12-43)

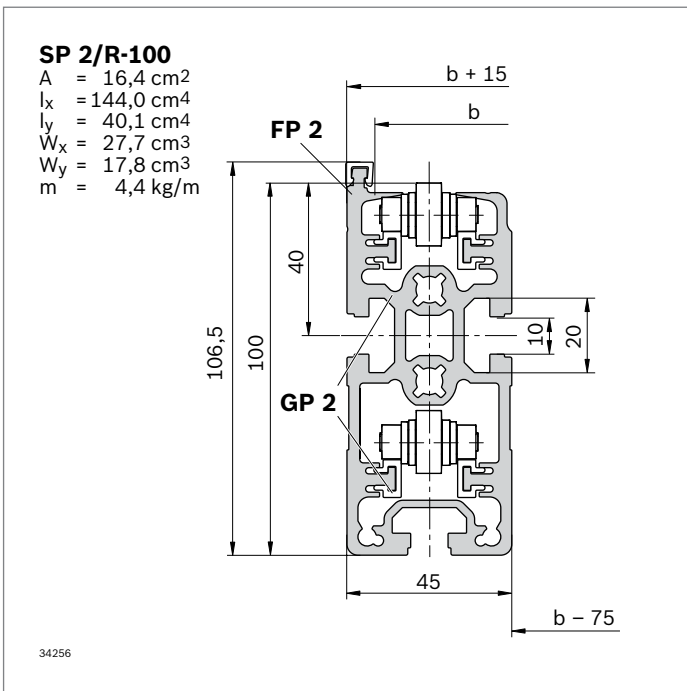

SP 2/R-100 section profile	L (mm)	No.
16 pcs	6070	3 842 529 931

Material: aluminum, natural-colored, anodized

Accessories: PA guide and slide profile (p. 12-42)
 ST guide and slide profile (p. 12-42)

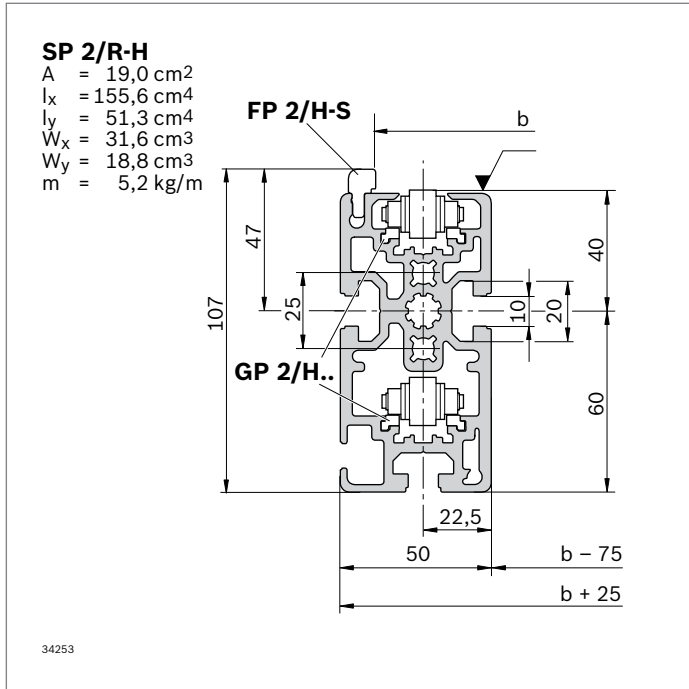

SP 2/R-H section profile		L (mm)	No.
12 pcs		6070	3 842 536 792
Material:	aluminum, natural-colored, anodized		
Accessories:	Guide profile FP 2/H-ST Slide profile GP 2/H-KST Slide profile GP 2/H-ST		

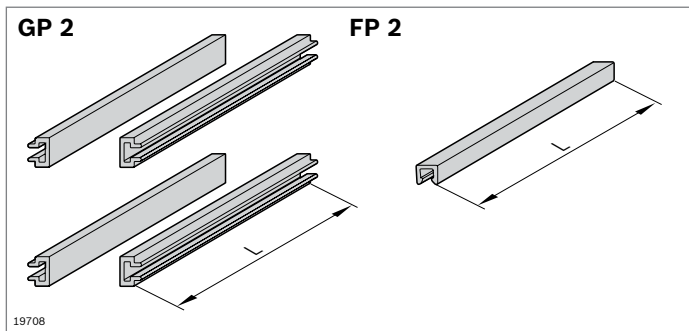

PA guide and slide profile		ESD	No.
			3 842 529 933
Material:	PA 12 (anti-static)		
Scope of delivery:	64 x slide profile GP 2 (L = 6000 mm) 16 x guide profile FP 2 (L = 6000 mm)		

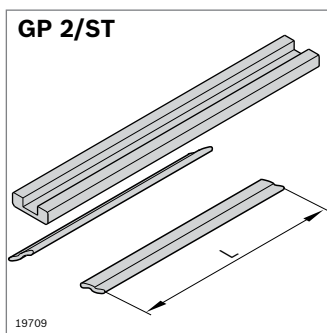

Guide and Slide Profile ST		ESD	No.
			3 842 532 676
Material:	GP 2/ST: steel; corrosion-resistant Guide profile for accumulation roller chain: PE		
Scope of delivery:	32 x slide profile GP 2/ST (L = 3000 mm) 24 x guide profile for accumulation roller chain (L = 2000 mm)		

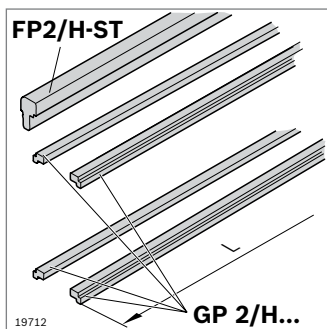

Guide profile		L (mm)	ESD	No.
FP 2/H-ST	24 pcs	3000		3 842 537 890
Material:	steel; corrosion-resistant			

Slide profiles		L (mm)	ESD	No.
GP 2/H-ST	48 pcs	3000		3 842 537 888
GP 2/H-KST	48 pcs	3000		3 842 537 889
Material:	H-KST: PA (anti-static) H-ST: steel; corrosion-resistant			

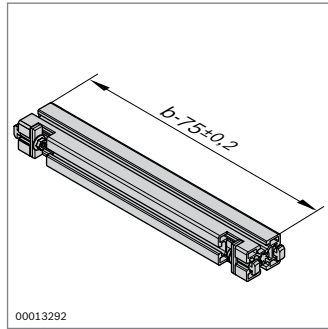
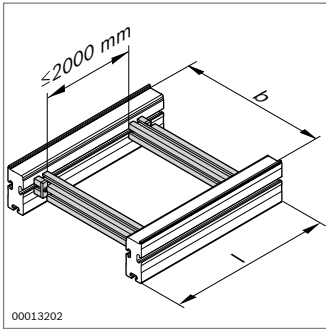

- ▶ Cross connector QV 2 for connecting two section profiles
- ▶ For defining the track width

QV 2 cross connector	b (mm)	No.
	160...1200	3 842 994 635 / b

Material: aluminum, natural-colored, anodized
Fastening material: Steel

Scope of delivery: Strut profile 45x60, 2 x QV mounting kit (p. 3-62)

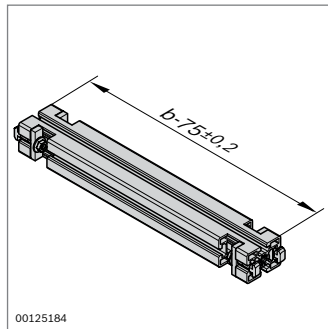
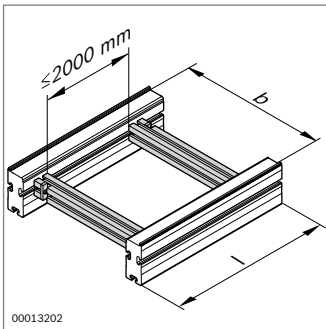

- ▶ Cross connector QV 2-H for connecting two section profiles
- ▶ For heavy applications
- ▶ For defining the track width

QV 2-H cross connector	b (mm)	No.
	160...1200	3 842 993 052 / b

Material: aluminum, natural-colored, anodized
Fastening material: Steel

Scope of delivery: Strut profile 45x60, 4 x QV mounting kit (p. 3-62)

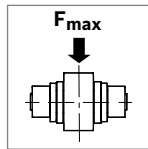
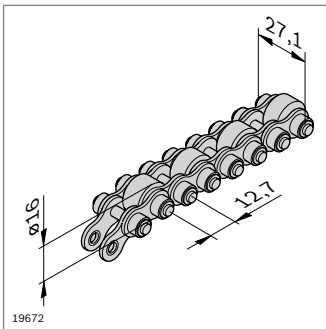

Accumulation roller chain	F _{max} (kg/cm)	L (mm)	No.
Support wheel: PA 12	1.5	12000	3 842 523 918
Support wheel: Steel	2.0 ¹⁾ /1.5 ²⁾	12000	3 842 530 864

¹⁾ When using slide profile GP 2/ST

²⁾ When using slide profile GP 2

Material: Accumulation roller chain: steel
Support wheel: see ordering table

Scope of delivery: incl. chain coupling

Accessories: additional chain coupling (**3 842 530 417**)

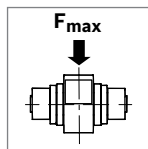
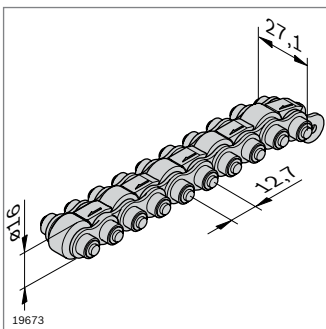

Accumulation roller chain with small parts trap	F _{max} (kg/cm)	L (mm)	No.
Support wheel: PA 12	1.5	12000	3 842 536 268
Support wheel: Steel	2.0 ¹⁾ /1.5 ²⁾	12000	3 842 536 270

¹⁾ When using slide profile GP 2/ST

²⁾ When using slide profile GP 2

Material: Accumulation roller chain: steel
Support wheel: see ordering table

Scope of delivery: incl. chain coupling

Accessories: additional chain coupling (**3 842 530 417**)

- ▶ Chain coupling for extending accumulation roller chains

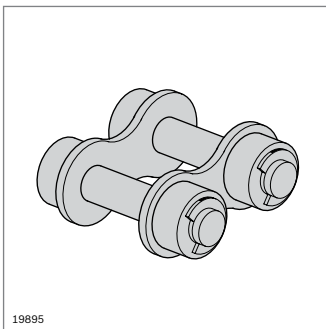

Master link	No.
	3 842 530 417

Material: Steel