

21407

Tilt lever

- ▶ For compliance with the requirement in Machinery Directive 2006/42/EC relating to the detaching of protective frames
 - The long-arm spring is designed so that it tilts the protective frame outwards, making it clear that the protective frame is detached
 - The protective frame cannot fall out
- ▶ Easily removable EcoSafe protective frames
- ▶ Can be retrofitted
- ▶ Installation on both sides recommended for EcoSafe protective frames of width $B > 1500$ mm

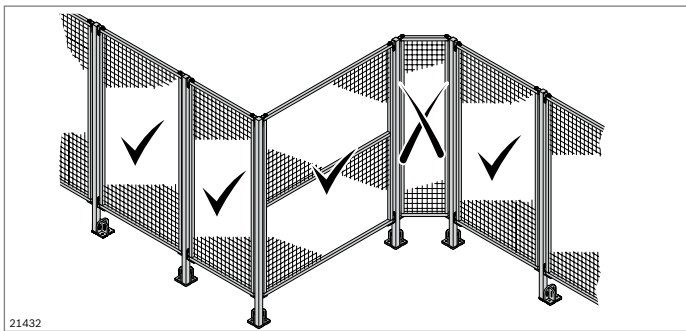

21432

Possible installation situation:

- ▶ not suitable for installing the protective frame across a corner

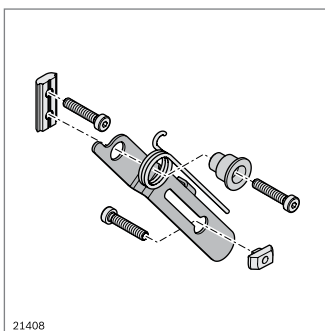

21408

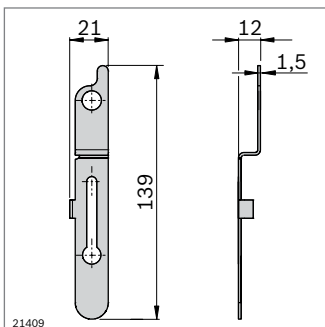
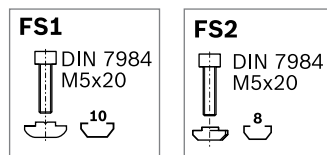

21409

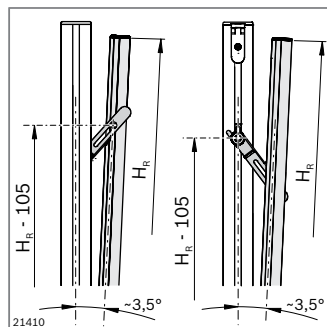

21410

Tilt lever	No.	FS
	3 842 546 560	FS1, FS2

Material: Fixing plate: Stainless steel
 Spacer: aluminum
 Long-arm spring: spring steel

Scope of delivery: holding plate, spacer, long-arm spring, fastening material (FS)