

## ESD leg set

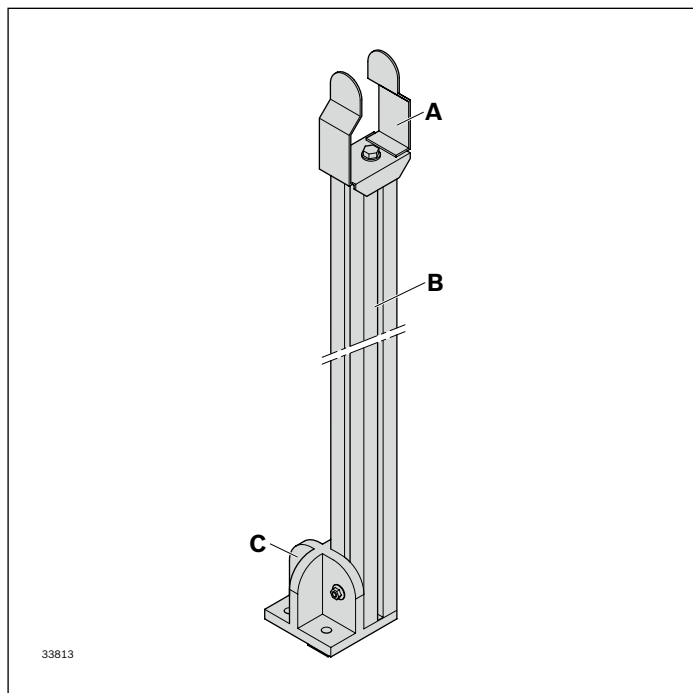

The STS T-nuts included in the scope of delivery of the STS holder (**A**) must be replaced with MGE T-nuts M8. The anodized layer is thereby pierced and connected to the conductive STS holder.

The connection between the STS holder (**A**) and the core pull of the AL strut profile (**B**) is established via the M12 hexagon screw of the STS holder.

Instead of the coated VarioFlow *plus* foot, the 120x120 base plate (**C**) included in the MGE program must be used. The connection of the base plate to the strut profile is done using T-bolts and flange nuts

## Required accessories:

- 4x T-bolts M8x30, 3 842 528 721, see page 63
- 4x flange nuts, 3 842 345 081, see page 63

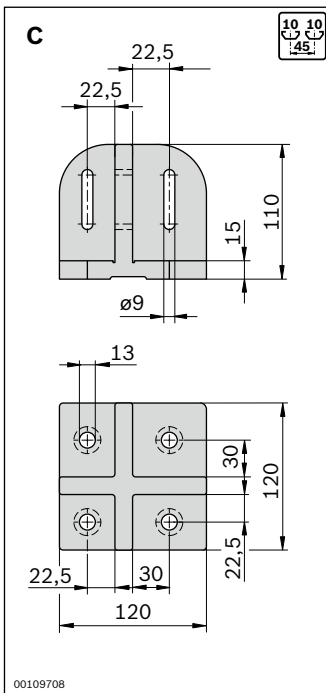
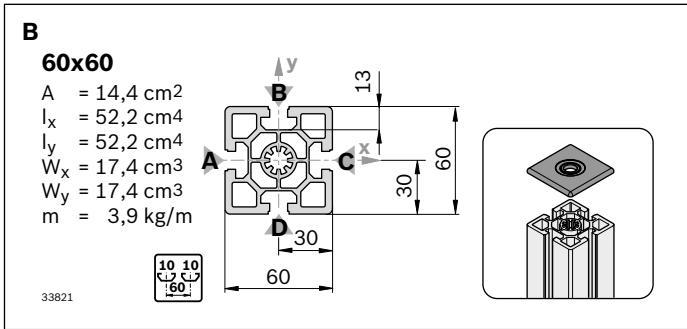
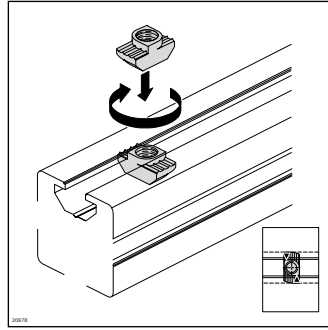
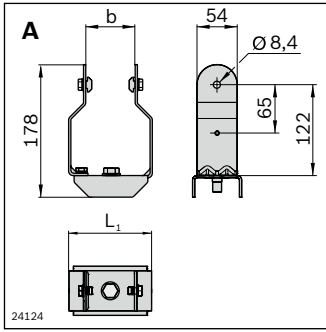

Holder STS	b (mm)	L <sub>1</sub> (mm)	ESD	No.
VFplus 65 support STS	65	111	Set	<b>3 842 546 658</b>
VFplus 90 support STS	90	136	Set	<b>3 842 546 659</b>

T-nut, 10 mm slot	Groove	M	ESD	No.
steel; galvanized	10	M8	100	<b>3 842 530 287</b>

Strut profile 60x60	L (mm)	No.
1 pcs M12	60 ... 5600	<b>3 842 990 351/L</b>

Profile finishing: Thread cutting M12, see MGE catalog, chapter Strut profiles

Cover cap with hole	ESD	No.
60x60, black	20	<b>3 842 548 811</b>

Base plate	ESD	No.
120x120	1	<b>3 842 527 553</b>

## ESD motor leg sets (STS drives on the AL system)

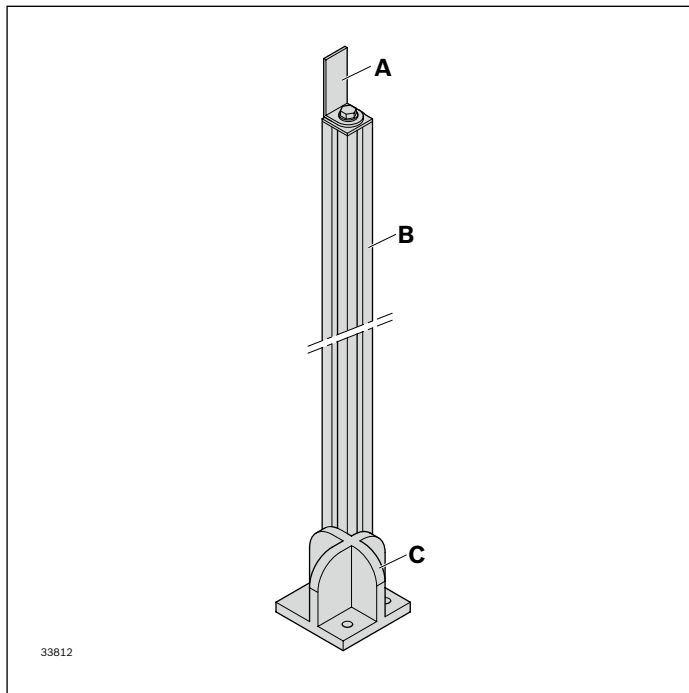

The connection between the STS motor leg set holder (**A**) and the core pull of the strut profile (**B**) is established via the M12 hexagon screw included in the scope of delivery of the holder.

Instead of the coated VarioFlow plus foot, the 120x120 base plate (**C**) included in the MGE program must be used. The connection of the base plate to the strut profile is done using T-bolts and flange nuts

### Required accessories:

- 4x T-bolts M8x30, 3 842 528 721, see page 63
- 4x flange nuts, 3 842 345 081, see page 63

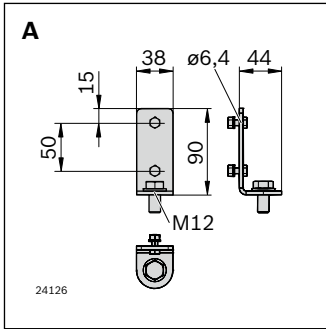

Holder engine support STS	No.
VFplus	Set 3 842 549 365

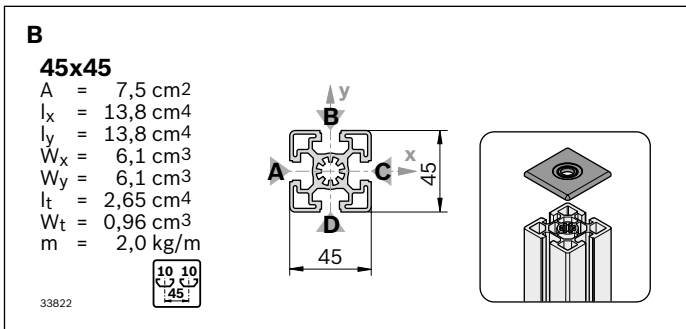

Strut profile 45x45	L (mm)	No.
1 pcs M12	60 ... 6000	3 842 990 517

Profile finishing: Thread cutting M12, see MGE catalog, chapter Strut profiles

Cover cap with hole	ESD	No.
45x45, black	20	3 842 548 797

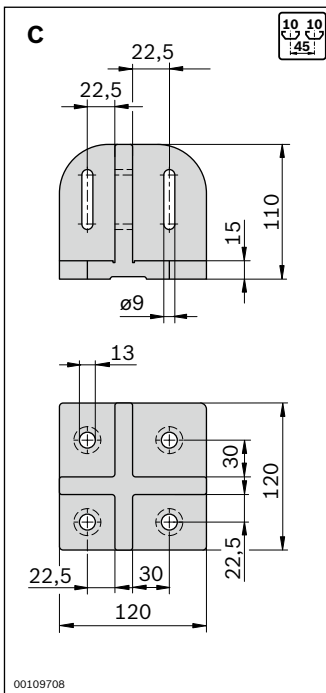

Base plate	ESD	No.
120x120	20	3 842 527 553